

SUMMERS®

Operator's Manual



IMPORTANT

THE OPERATOR IS RESPONSIBLE
FOR ADJUSTING THE MACHINE
SINCE MACHINE DOES NOT COME
"FIELD READY" FROM FACTORY.



CAUTION

READ & UNDERSTAND OPERATOR'S
MANUAL BEFORE USING MACHINE.

See www.summersmfg.com for latest version of all Summers Operator's Manuals.

SUMMERS MANUFACTURING CO., INC.

WEB SITE: www.summersmfg.com

DEVILS LAKE, NORTH DAKOTA 58301

(701) 662-5391

Warranty

Summers warrants only products of its manufacture against operational failure caused by defective materials or workmanship which occur during normal use within 36 months from the date of purchase by the end user from Summers' dealer.

Summers' obligation is to replace free of charge any part of any product that Summers inspection shows to be defective excluding transportation charges to Devils Lake, ND and return and also excluding all transportation costs from Summers' dealer to the dealer's customer and all other costs such as removal and installation expense.

Summers shall not be liable for loss of time, manufacturing costs, labor, material, loss of profits, consequential damages, direct or indirect, because of defective products whether due to the rights arising under the contract of sale or independently thereof, and whether or not such claim is based on contract, tort or warranty.

Written permission for any warranty claim return must be first obtained from authorized Summers personnel. All returns must be accompanied with a complete written explanation of claimed defects and the circumstances of operational failure.

Written warranty for all component parts used in the manufacture of Summers products is available upon request. Warranty of such component parts will be determined by said component manufacturer upon their inspection of the claimed defective part.

This express warranty is the sole warranty of Summers. There are no warranties, which extend beyond the warranty herein expressly set forth. The sales for products of Summers under any other warranty or guarantee express or implied is not authorized. This warranty voids all previous issues.

SUMMERS MANUFACTURING CO., INC.

DEVILS LAKE, NORTH DAKOTA 58301

01/16

Publish Date: 01/18/2021

GENERAL INFORMATION

This book is composed of four basic sections: Safety, Assembly, Operation and Maintenance, and Parts. The Assembly Section provides complete instructions for the proper assembly of your Summers SuperCoulter Samurai. The Operation Section provides information for the proper operation and maintenance of your Summers SuperCoulter Samurai. A complete parts breakdown is provided in the Parts Section.

Parts are referenced in each drawing with the Summers Manufacturing Part Number. Use this Part Number when ordering replacement parts from your Summers dealer. See back section of manual for description of each Part Number.

Reference to “Right” and “Left” in this book is determined when the machine is viewed from the rear.

It is the policy of this company to improve its products whenever possible and practical to do so. We reserve the right to make changes or improvements in the design or construction of parts at any time without incurring the obligation to install such changes on products previously delivered.

Summers Manufacturing Company, Inc. strongly recommends that each Operator READ and UNDERSTAND the Operator’s Manual before using the machine. In addition, this Operator’s Manual should be REVIEWED at least ANNUALLY thereafter.

Scan code to the right for the latest version of all Summers Operator’s Manuals.



SECTION CONTENTS

Section 1: **SAFETY**

Section 2: **ASSEMBLY INSTRUCTIONS**

Section 3: **OPERATION, MAINTENANCE AND SPECIFICATIONS**

Section 4: **PARTS**

OWNER REGISTER

Name _____

Size _____

Address _____

Serial Number _____

City _____

(located by the hitch piece)

Stat/Prov. _____

Date Purchased _____

Mail Code _____

Dealer _____

TABLE OF CONTENTS

SECTION 1 – SAFETY

SAFETY ALERT SYMBOL & GENERAL SAFETY PRACTICES.....	[1.1]
SAFETY DURING TRANSPORT.....	[1.2]
SAFETY DECALS.....	[1.2]-[1.6]

SECTION 2 – ASSEMBLY

KNOCK-DOWN ASSEMBLY.....	SEE ASSEMBLY MANUAL
FINAL ASSEMBLY OF SETUP MACHINE.....	[2.1]-[2.5]
MOUNTED ATTACHMENT ASSEMBLY.....	[2.6]-[2.8]

SECTION 3 – OPERATION, MAINTENANCE AND SPECIFICATIONS

CONNECTING TO THE TRACTOR.....	[3.1]
PREPARING FOR FIELD OPERATION.....	[3.2]
TRANSPORT.....	[3.3]
DISCONNECTING FROM TRACTOR.....	[3.3]
STORAGE.....	[3.3]
FIELD OPERATION.....	[3.3]
TROUBLESHOOTING.....	[3.4]
MACHINE SPECIFICATIONS.....	[3.4]
MAINTENANCE.....	[3.5]

SECTION 4 – PARTS

HITCH.....	[4.1]
30' CENTER & WINGS.....	[4.3]-[4.8]
40' CENTER & WINGS.....	[4.9]-[4.14]
50' CENTER & WINGS.....	[4.15]-[4.20]
LIGHTING.....	[4.21]
DECALS.....	[4.23]
GANG PARTS.....	[4.25]
REAR ATTACHMENT MOUNTING ARM ASSEMBLY.....	[4.27]
MOUNTED HARROW ASSEMBLY.....	[4.29]
ROLLING BASKET ASSEMBLY.....	[4.31]
HUBS/AXLES.....	[4.33]-[4.36]
HYDRAULIC LAYOUTS.....	[4.37]-[4.43]
PART NUMBERS & DESCRIPTIONS.....	[4.44]-[4.47]

SECTION 1 - SAFETY

SAFETY-ALERT SYMBOL



This symbol is used to denote possible danger and

Care should be taken to prevent bodily injury.

This symbol means:

ATTENTION! BECOME ALERT!

YOUR SAFETY IS INVOLVED!

Definition of each **Signal Word** used in conjunction with the **Safety-Alert** symbol.



Indicates an imminently hazardous situation which, if not avoided, will result in death or serious injury. This signal word is limited to the most extreme situations.



Indicates a potentially hazardous situation which, if not avoided, could result in death or serious injury.



Indicates a potentially hazardous situation which, if not avoided, may result in minor or moderate injury. It may also be used to alert against unsafe practices.

GENERAL SAFETY PRACTICES

1. READ AND UNDERSTAND Operator's Manual before using machine. Review at least annually thereafter.
2. VERIFY all safety devices and shields are in place before using machine.
3. KEEP hands, feet, hair and clothing away from moving parts.
4. STOP engine, place all controls in neutral, set parking brake, remove ignition key and wait for all moving parts to stop before servicing, adjusting or maintaining.
5. USE CYLINDER LOCKS or lower hydraulically elevated implement components.
6. BE CAREFUL when working around high pressure hydraulic system.
7. DO NOT ALLOW RIDERS.
8. EXERCISE EXTREME CARE when working on or near disk blades. Samurai™ blades are extremely sharp, especially when new.

SECTION 1 - SAFETY

SAFETY DURING TRANSPORT

1. ONLY TOW at a safe speed. Use caution when making corners and meeting traffic. Maximum transport speed is 20 mph (32 kph). Towing vehicle must weigh a minimum of 1.5x the weight of the implement. (See table on page 3.4)
2. USE safety chain between tractor drawbar and implement hitch when transporting on public roads.
3. ALWAYS use transport locks when transporting on public roads.
4. COMPLY with local lighting, marking and oversize regulations when transporting on highways.
5. FREQUENTLY check for traffic from rear, especially during turns.

SAFETY DECALS

1. Keep safety decals clean.
2. Replace missing or unreadable decals. New decals are available from your Summers dealer by ordering correct part number (PN) located on decal.
3. Locations shown in Parts section.

1. TRANSPORT LOCK WARNING DECAL (PN 8Z0075)



2. PINCH POINT DECAL (PN 8Z0087)



SECTION 1 - SAFETY

3. DISCONNECTING IMPLEMENT WARNING DECAL (PN 8Z0099)



4. REAR JACK DECAL (PN 8Z0102)



5. GENERAL CAUTION DECAL (PN 8Z0276)

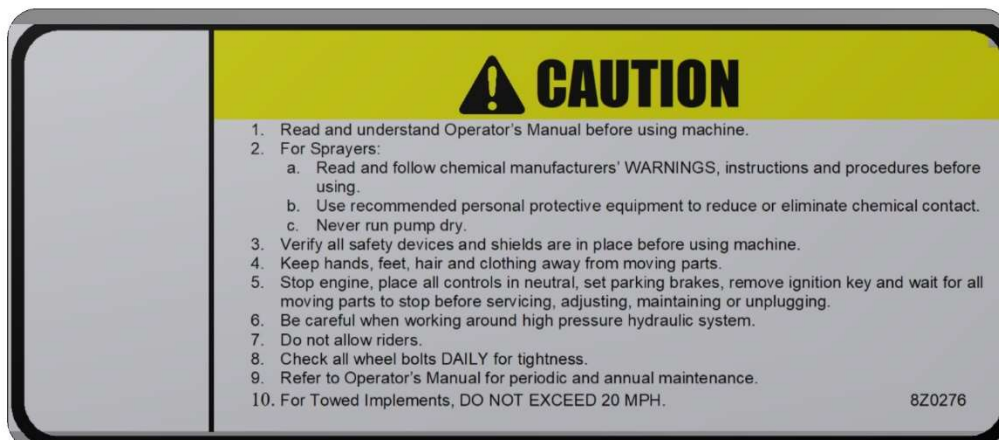

SECTION 1 - SAFETY

6. REPHASING CYLINDERS DECAL (PN 8Z0340)

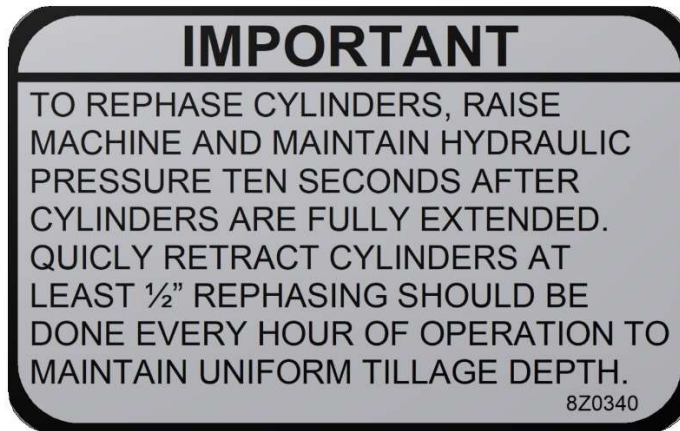

7. INSTALLING CYLINDER LOCKS DECAL (PN 8Z0342)



8. STAYING CLEAR OF WINGS DECAL (PN 8Z0344)



SECTION 1 - SAFETY

9. ROLLING ATTACHMENT DANGER DECAL (PN 8Z0345)



10. ELECTROCUTION DANGER DECAL (PN 8Z0346)



11. AMBER REFLECTOR (PN 8Z0800)

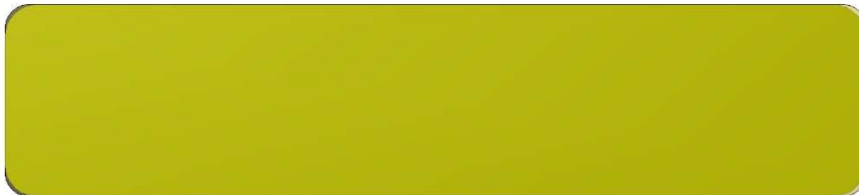

SECTION 1 - SAFETY

12. RED-ORANGE REFLECTOR (8Z0805)



13. RED REFLECTOR (PN 8Z0810)



SAFETY LIGHT OPERATION

The Summers Safety Light Kit is equipped with a 7-pin connector which meets SAE J560 specification. To protect 7-pin connector, store in dust cap (PN 8K8067) when not attached to towing vehicle.



HITCH ATTACHMENTS

- Bolt 8N0700 to the frame
- Then attach 8Z1010 and 8K8067
- **30 - 40:** 8D0760 & 8D2470
- **50:** 8D0770 & 8D2480

Part Number	Qty
8D0760	1
8D2470	1
8N0700	1
8N0704	1
8N0705	1
8X0021	5
8X0110	1
8X0146	4
8X0203	4
8X0211	5
8X0281	4
8X0318	1
8X0329	3
8X1110	4
8Z1010	1

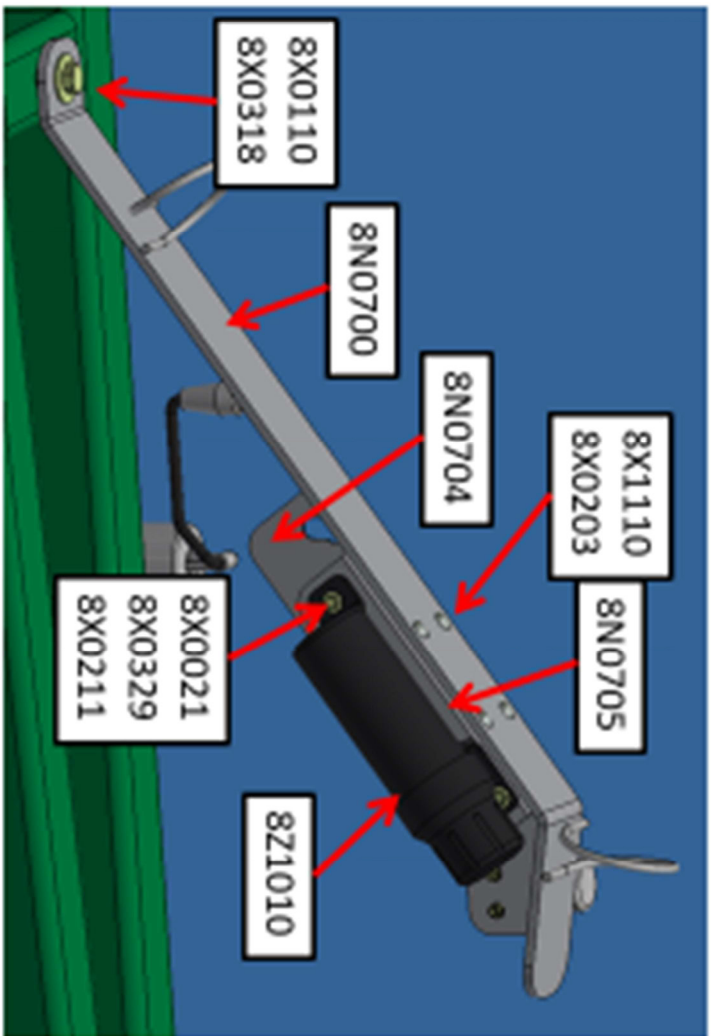
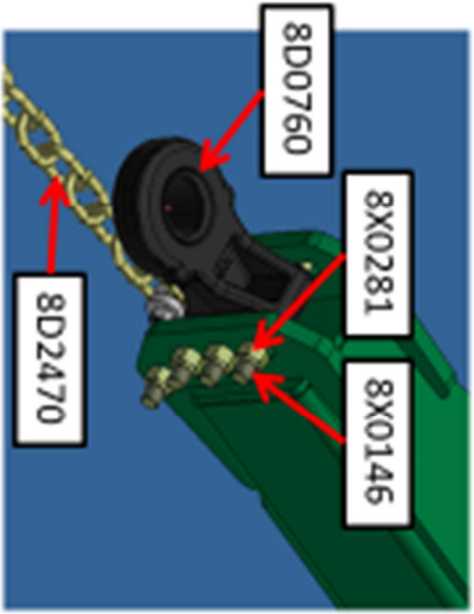

ATTACHMENT BRACKET

- First attach 8H3000B to the frame using 8D0340
- Attach 8B2175, 8H3080S, and 8H3040 to 8H3000B
- Then bolt 8B2175 to 8H3080S using 8X0113
- Attach 8H3025, 8H3028, and 8X0492 to center harrow arms

Part Number	Qty per Bracket
8B2175	1
8D0340	2
8H2005	2
8H3000B	1
8H3040	1
8H3080S	1
8X0113	1
8X0121	4
8X0260	4
8X0261	5
8X0306	4

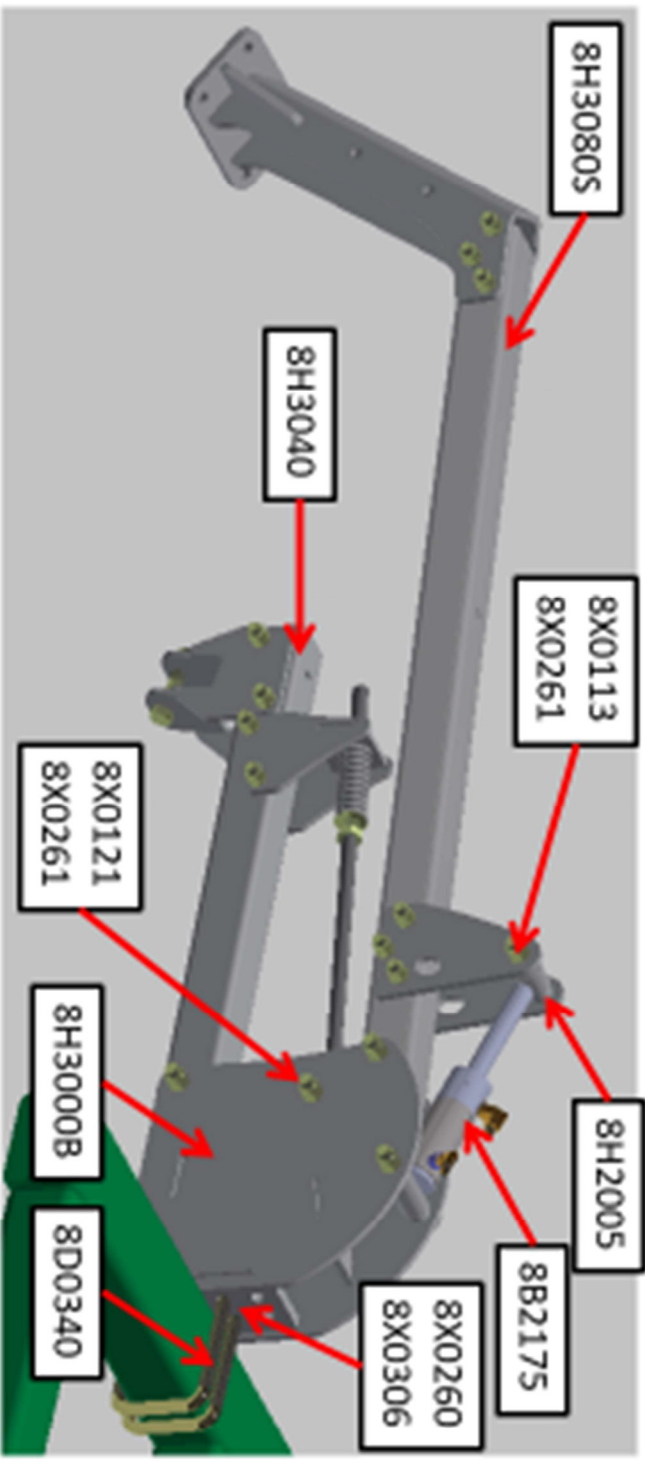

ATTACHMENT BRACKET ASSEMBLY

Part Number	Qty per Bracket
8H1290	1
8H1295	1
8X0271	1
8X0269	1
8X0274	1

- Tighten 8X0271 so there is 2- $\frac{3}{4}$ " between the nut and the end of the spring rod

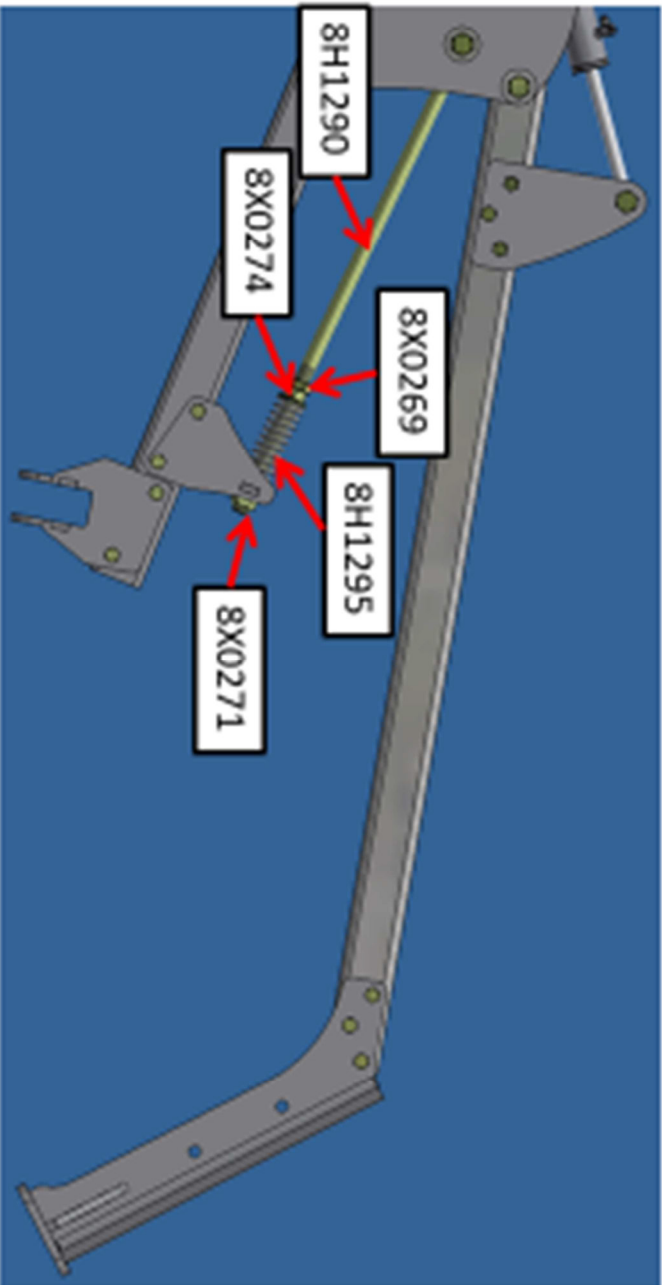

BASKET LOCKUP

- Arms on Center Section ONLY

Part Number	Qty per Bracket
8H3025	1
8H3028	1
8X0317	1
8X0492	1

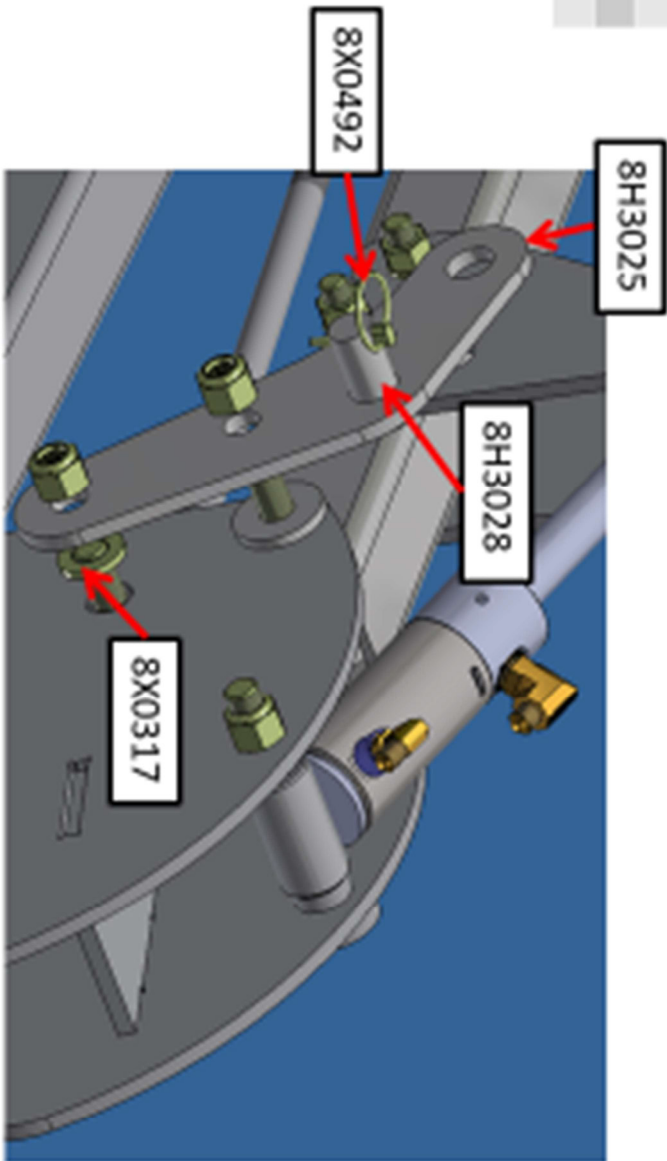

SECTION 2 - ASSEMBLY

**30' SUPERCOOLTER SAMURAI
HARROW/HYD. BASKET**

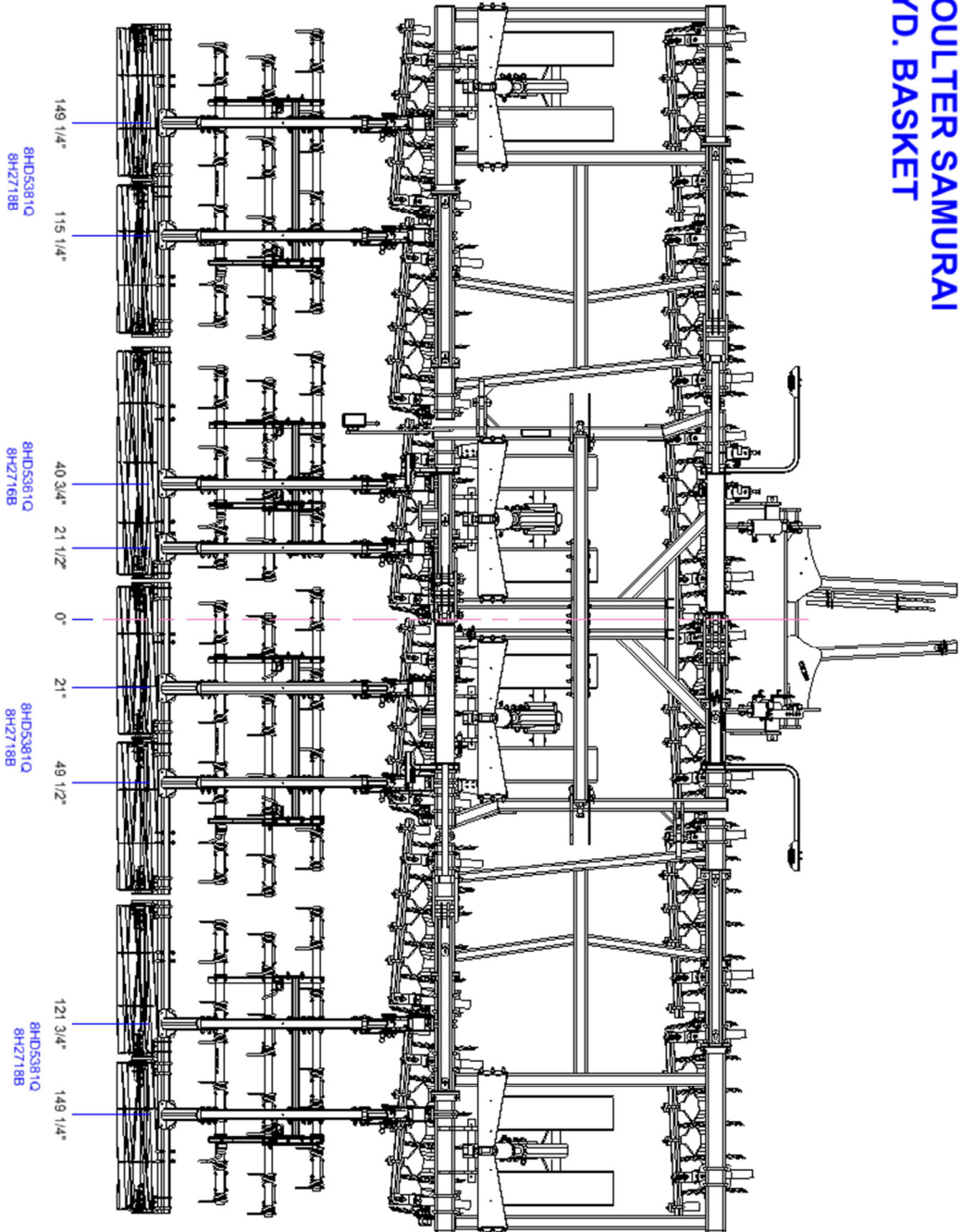

4/7/2021

910300.kem/30' SC SAMURAI
HRRW/BSKT LAYOUT

SECTION 2 - ASSEMBLY

**40' SUPERCOULTER SAMURAI
HARROW/HYD. BASKET**

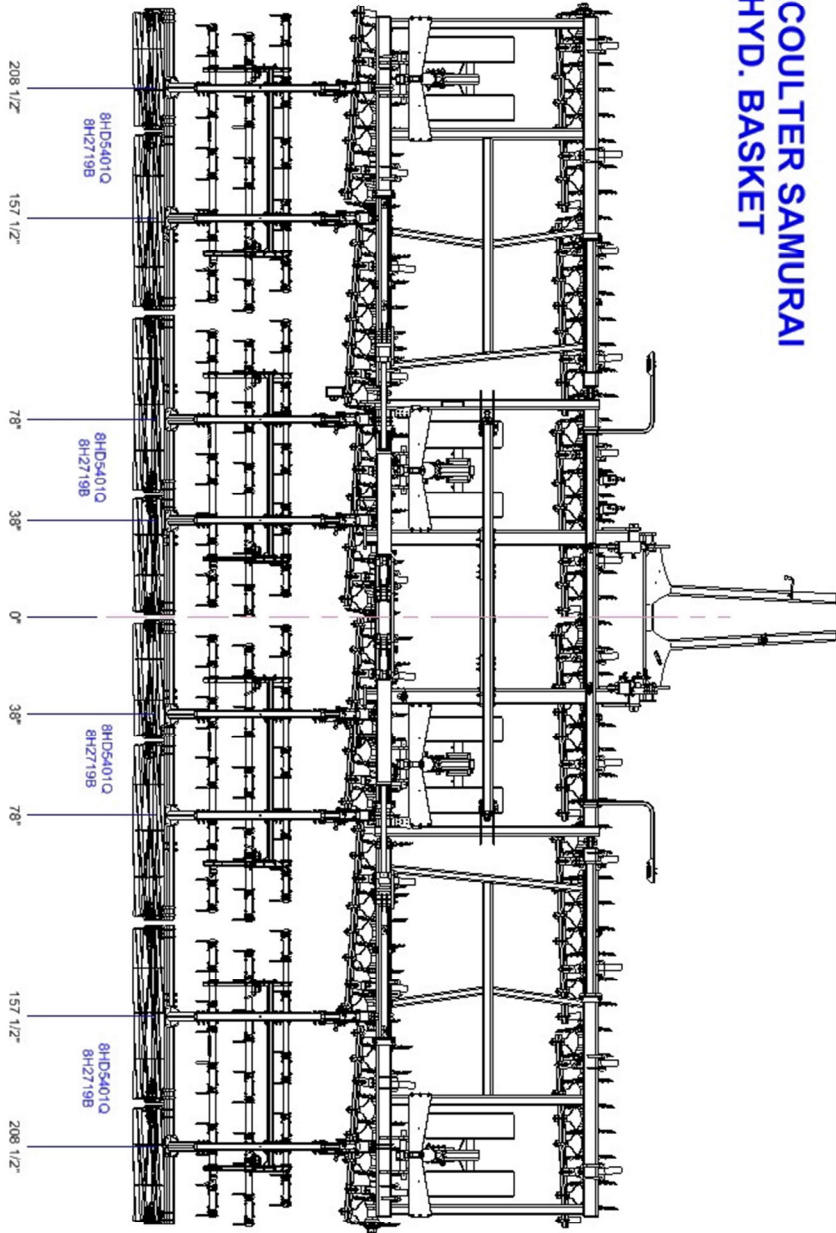

2/5/2020

9J0400Jani40' SAM CLTR
HRRV/BSKT LAYOUT

SECTION 3 – OPERATION, MAINTENANCE & SPECIFICATIONS

CONNECTING TO THE TRACTOR

The Summers SuperCoulter Samurai™ is equipped with an Articulating Ball hitch. This hitch is designed to eliminate “slop” between the implement hitch and the tractor drawbar. 30’ and 40’ machines are supplied with a Category 4 hitch and must be used with a 2” diameter hitch pin. 50’ machines are supplied with a Category 5 hitch and must be used with a 2-3/4” diameter hitch pin. A reducing bushing is also supplied to adapt to a Category 4 drawbar.

The SuperCoulter Samurai™ has 4 hydraulic circuits, Lift/Depth Control, Wing Fold/Downpressure, Hitch and Rolling Basket Downpressure. After connecting the hoses to the tractor, the flow controls should be set as follows:

Green: Main Lift/Depth Control

Red: Hitch

Gold: Wing Fold/Downpressure. **MUST BE IN CONSTANT FLOW**, 60% flow. Alternatively, wing circuit can be run in Float.

Blue: Basket Lift/Downpressure. **MUST BE IN CONSTANT FLOW WHEN APPLYING DOWNPRESSURE**, 60% flow. Alternatively, basket circuit can be run in Float.

ELECTRICAL HOOKUP

The Summers Safety Light Kit is equipped with a 7 pin connector which meets SAE J560 specification. To protect the 7 pin connector, store in dust cap when not attached to towing vehicle.



SECTION 3 – OPERATION, MAINTENANCE & SPECIFICATIONS

BEFORE INITIAL OPERATION

Remove the transport locks from the center section Rolling Baskets, shown below.

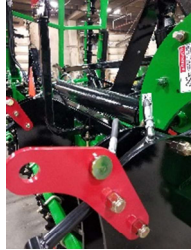

Failure to remove transport locks may result in damage to the machine.

REMOVE SAFETY LOCKS

Remove wing and lift cylinder locks.

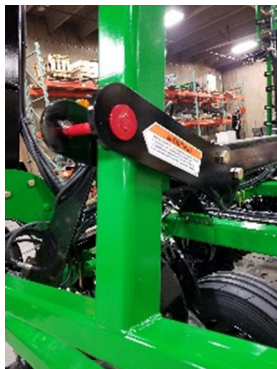

Wing Locks

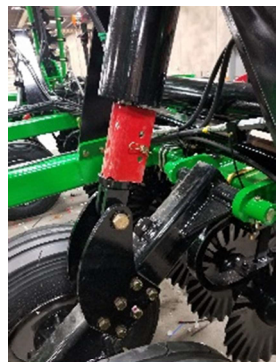

Lift Cylinder Locks

Open Hydraulic Hitch Ball Valve and remove the cylinder stops from the hitch cylinders.

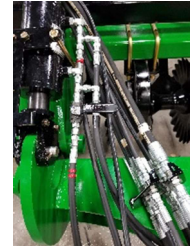

Ball Valve

Remove rear jack and place into storage location.

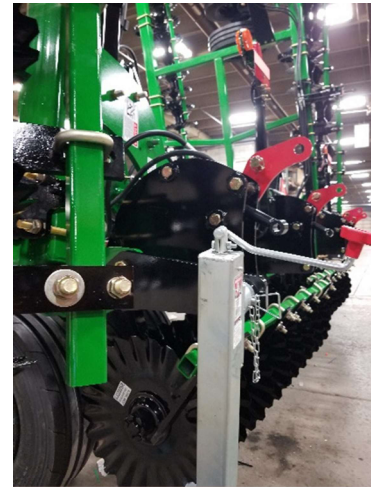

Rear Jack Down

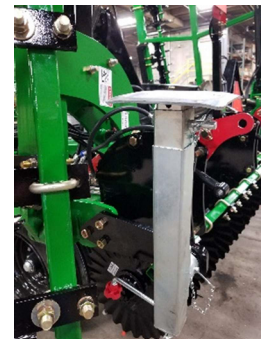

Rear Jack Stored

SECTION 3 – OPERATION, MAINTENANCE & SPECIFICATIONS

TRANSPORTING

Before transporting, close hitch circuit ball valve on center of main frame, and install all transport locks.

Use a safety chain between tractor drawbar and SuperCoulter Samurai™ hitch when transporting on public roads.

Check wheel bolts/nuts after first 20 miles of road transport and every 60 miles thereafter.

Road the implement at a reasonable speed, not to exceed 20 MPH.

NOTE: Towing vehicle must weigh a minimum of 1.5x the implement weight. (See table on page 3.4)

Always use an ASABE “Slow Moving Vehicle” emblem and safety lights when transporting on a road or highway. Comply with your state and local laws governing lighting and maximum width regulations. Transport during daylight hours only.

UNHOOKING FROM SUPERCOUNTER SAMURAI™

Choose a very firm level surface to park.

Either lower wings and blades to the ground OR install Wing and Lift Cylinder transport locks.

Check that hitch pin is not bound with sideways or front to back pressure. If hitch pin is not free, carefully reposition tractor.

Block tires to prevent movement after hitch pin is removed.

Lower front AND rear jacks.

Disconnect light harness, hydraulic hoses, and safety chain.

Recheck that hitch pin is free, if so, stand to the side of the hitch and remove hitch pin.

Carefully drive ahead.

STORAGE

Inspect machine for damaged or worn parts, cracked or broken blades, and loose bolts.

Wheel bearings should be inspected seasonally.

It is recommended to store machine unfolded, with both the blades and tires on the ground. If this is not feasible, ensure:

-Lift Cylinder Locks are in place

-Wing Lock pins are in place

-Hitch Ball Valve is closed

-Rolling Basket Shipping Locks are installed

-Front AND rear jacks are lowered

-Wheels are chocked

FIELD OPERATION

Unfold wings and lock hydraulic flow in constant in the extend direction.

Lower rolling baskets and lock hydraulic flow in constant in the extend direction. Alternatively, the machine can be run with the baskets in the raised position. In this instance, constant hydraulic flow is not needed.

To limit tillage depth, cylinder stop collars are provided. They should only be placed on the master cylinder (Left Center).

NOTE: Reduce speed, reduce cutting depth, put hitch in float, and use minimum ballast and wing downpressure when working in rocky conditions. DO NOT turn with blades in ground in rocky or frozen conditions. Damage will occur to machine if operated at more than 5.5 MPH in rocky or frozen conditions. This damage is NOT covered by warranty.

SECTION 3 – OPERATION, MAINTENANCE & SPECIFICATIONS

TROUBLESHOOTING

NO.	PROBLEM	PROBABLE CAUSE	CORRECTION
1	Wings will not unfold	A. Hydraulic flow set too low	Increase hydraulic flow on the tractor
		B. Safety pins in place	Remove pins
2	Wings are not penetrating	A. Wing Downpressure too low	Increase wing pressure
		B. Basket pressure too high	Reduce basket pressure
3	Wings are going in too deep.	A. Wing Downpressure too high	Reduce wing pressure
4	Machine is not running level front to back	A. Hitch not in correct position	Adjust hitch angle
			Run hitch in float
5	Gangs Plugging	A. Extremely wet field conditions	Allow to dry
			Adjust machine to run rear gangs deeper
6	Hydraulic cylinders not synchronized	A. Hydraulics have drifted or air has entered the system	Rephase Main Lift circuit by extending lift cylinders and holding lever for a minimum of 10 seconds
7	Gang nuts do not stay tight	A. Gangs have run loose for an extended period of time	Disassemble gang, clean and replace worn components
8	Machine drifts to the right	A. Too much weight on rear of machine	Adjust hitch to pitch machine forward
			Increase Rolling Basket downpressure
9	Machine drifts to the left	A. Too much weight on front of machine	Adjust hitch to pitch machine rearward
			Decrease Rolling Basket downpressure

SPECIFICATIONS

SIZE	TRANSPORT WIDTH	TRANSPORT HEIGHT	MACHINE WEIGHT	OVERALL LENGTH
30'	15'-11"	14'-1"	21,800	32'-1"
40'	19'-10"	16'-3"	25,600	32'-1"
50'	19'-10"	16'-6"	34,000	32'-1"

*Dimensions and Weights are approximate

SECTION 3 – OPERATION, MAINTENANCE & SPECIFICATIONS

MAINTENANCE

- Every 40 hours:** Grease articulating ball hitch.
- Seasonally:** Grease Fold Cylinder Pivot.
- Inspect and re-pack Wheel Bearings.
- Check Wheel Bolt/Nut torque.

Tire Inflation: Recommended inflation pressures in chart below.

Hub	PN	Wheel Bolt/Nut Torque	Size	Load Index	Pressure
812 - 8 BOLT	8K1105	240 ft-lb			
817 - 8 BOLT	8K1106	240 ft-lb	VF385/65R22.5	163	70 psi
1010 - 10 BOLT	8K1109	275 ft-lb	VF285/70R19.5	150	75 psi

PROPER BOLT USE

DO NOT use these values if a different torque value or tightening procedure is given for a specific application. Torque values listed are for general use only. Check tightness of fasteners periodically.

BOLT SIZE	WRENCH SIZE	GRADE 5		GRADE 8	
		ft-lbs	N-m	ft-lbs	N-m
1/4"	7/16" or 3/8"	7	9.5	12	17
5/16"	1/2"	15	20	25	34
3/8"	9/16"	30	41	45	61
7/16"	5/8" or 11/16"	45	61	70	95
1/2"	3/4"	70	95	105	142
9/16" Wheel Bolts	7/8"	170	231		
5/8"	15/16"	170	231	210	285
5/8" Wheel Nuts	1-1/16"	240	325		
3/4"	1-1/16"* or 1-1/8"	250	339	375	509
3/4" Wheel Nuts	1-1/8"	275	373		
7/8"	1-5/16"	350	475	600	814
1"	1-1/2"	450	610	880	1193
1-1/4"	1-7/8"	500	678		
1-1/2"	2-1/4"	570	773		
2"	3-1/8"	1200	1627		
METRIC					
M5	3 mm socket or 8 mm	22 in-lb	2.5 N-m		
M6	4 mm socket	70 in-lb	8 N-m		
*Nylon Lock Nut					

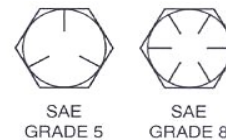
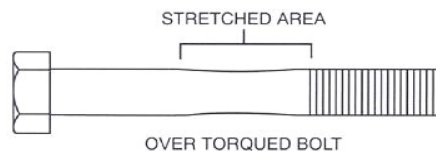

SECTION 4 - PARTS

ITEM	PN	DESCRIPTION
1	8CC0800	DEPTH INDICATOR CYL CLAMP
2	8CC0810	DEPTH INDICATOR POINTER
3	8D0770	HITCH ARTIC. BALL CAT 5 (50')
4	8D2480	SAFETY CHAIN 61000# 5/8" X 66"
5	8D8523	JACK 8000# DROPLEG 5/8X4.25PIN
6	8J1195	WEIGHT HTCH SCS OUTER
7	8J1197	WEIGHT HTCH SCS INNER
8	8J1200P	HITCH 40'-50' SCS-PNTD
9	8J1930	GAUGE 4" STROKE
10	8K3002	GANG WRENCH
11	8K8067	DUST CAP FOR 7PIN CONNECT00-
12	8N0700	HYD HOSE ARM
13	8N0704	HYD HOSE TIP HOLDER-4 PAIR
14	8P3900	PIN 2 X 11-1/8" HARDENED
15	8X0001	BOLT 3/8-16NC X 3/4" GR5 ZDI
16	8X0015	BOLT 3/8-16NC X 3-3/4" GR5 ZDI
17	8X0021	BOLT 5/16-18NC X 3/4" GR5 ZDI
18	8X0077	BOLT 1/2-13NC X 7-1/2" GR5 ZDI
19	8X0095	BOLT 5/8-11NC X 5" GR5 ZDI
20	8X0110	BOLT 3/4-10NC X 1-1/4" GR5 YZ
21	8X0129	BOLT 3/4-10NC X 11" GR5 YZ
22	8X0146	BOLT 1-8NCX8.5" W/1.5"THD GR5ZDI
23	8X0203	NUT 3/8"-16NC SERFLANG GR2 YZ
24	8X0211	NUT 5/16"-18NC SERFLANG GR2 YZ
25	8X0253	NUT 5/8"-11NC NY-LOCK GR2 YZ
26	8X0260	NUT 3/4"-10NC HEX GR2 YZ
27	8X0281	NUT 1"-8NC NY-LOCK GR2 YZ
28	8X0306	LOCKWASHER 3/4" YLW ZNC
29	8X0318	WASHER 3/4"(13/16"ID)FLAT YZ
30	8X0329	WASHER 5/16"(3/8" ID)FLAT YZ
31	8X0558	RIVET 3/16 SML FLNG .375"
32	8X1110	CRG 3/8-16NC X 1" GR2 ZN
33	8Z1010	MANUAL HOLDER TUBE

SECTION 4 - PARTS

30' SUPERCOUNTER SAMURAI

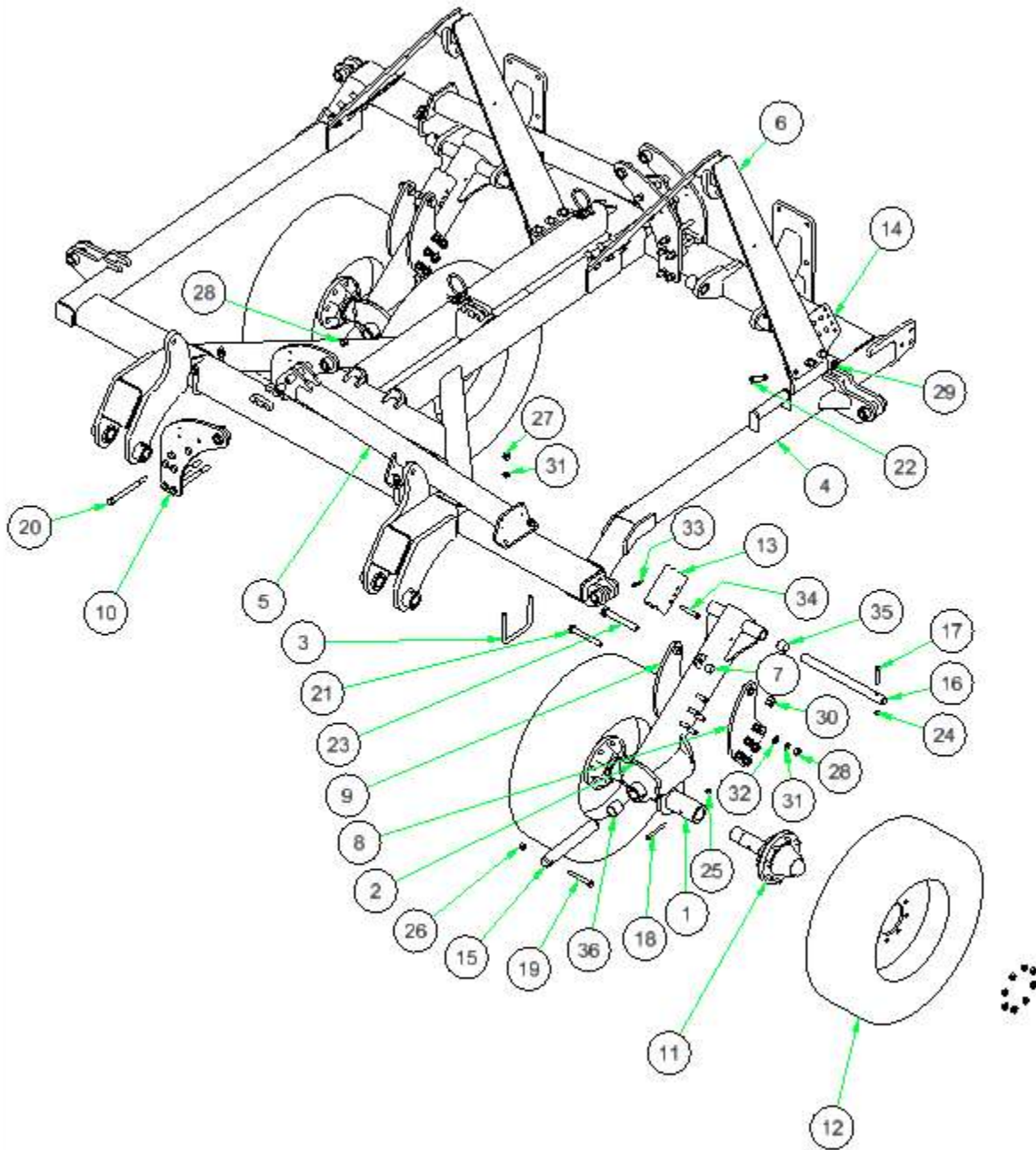

2/3/2021

40' SC SAMURAI CENTER TRANS

SECTION 4 - PARTS

ITEM	PN	DESCRIPTION
1	8B1270B	OSC AXLE SPNDLE HLDR 2.5"
2	8B2540	LIFTARM OSC AXL-RNGD
3	8C1755	U-BOLT 3/4 X 6-1/16 X 6" SQ
4	8J1208P	FRAME CENTER 30' SCS-PTD
5	8J1239	TRUSS CENTER SCS
6	8J1250	A-FRAME SCS
7	8J1268	SPACER 1"ID X 1"W
8	8J1270L	CYL ATTCH VF285 OSC-L
9	8J1270R	CYL ATTCH VF285 OSC-R
10	8J1277	WINGFOLD CYL ATTACH SCS
11	8K1106	HUB&AXLE ASSY HD817 (2.5"RCVR)
12	8K7410	285/70R 19.5 ON 19.5X8.25X8WHL
13	8K9200	TRNS LCK FRMD 7.5"(2-3/8"ROD)
14	8N0202B	BULKHEAD PLATE (Prior 2023-8N0202)
15	8P3910	PIN 2 X 13-1/2" HARDENED
16	8T3640	PIN 1-1/2 X 19" HARDENED 98-
17	8X0044	BOLT 7/16-14NC X 3-1/2"GR5 ZDI
18	8X0074	BOLT 1/2-13NC X 4-1/2" GR5 ZDI
19	8X0095	BOLT 5/8-11NC X 5" GR5 ZDI
20	8X0120	BOLT 3/4-10NC X 9" GR5 YZ
21	8X0121A	BOLT 3/4-10NCX6-1/2" -1.38"THD
22	8X0133	BOLT 7/8-9NC X 3" GR5 ZDI
23	8X0140	BOLT 1-8NCX7" W/1.5"THDGR5 YZ
24	8X0234	NUT 7/16"-14NC NY-LOCK GR2 ZDI
25	8X0242	NUT 1/2"-13NC NY-LOCK GR2 YZ
26	8X0253	NUT 5/8"-11NC NY-LOCK GR2 YZ
27	8X0260	NUT 3/4"-10NC HEX GR2 YZ
28	8X0265	NUT 3/4"-10NC CNTRLOCK GR2 YZ
29	8X0270	NUT 7/8"-9NC CNTRLOCK GR2 YZ
30	8X0281	NUT 1"-8NC NY-LOCK GR2 YZ
31	8X0306	LOCKWASHER 3/4" YLW ZNC
32	8X0317	WASHER 3/4" SAE FLAT YZ
33	8X0402	HAIR PIN CLIP 1/8 X 2-9/16"
34	8X0440	CLEVIS PIN 5/8 X 3-7/8" ZDI
35	8X3130	SLEEVEBRNG 1.656X1.5" ID- 1.5"
36	8X3140	SLEEVEBRNG 2.188X2" ID- 2"

SECTION 4 - PARTS

30' SUPER COULTER SAMURAI

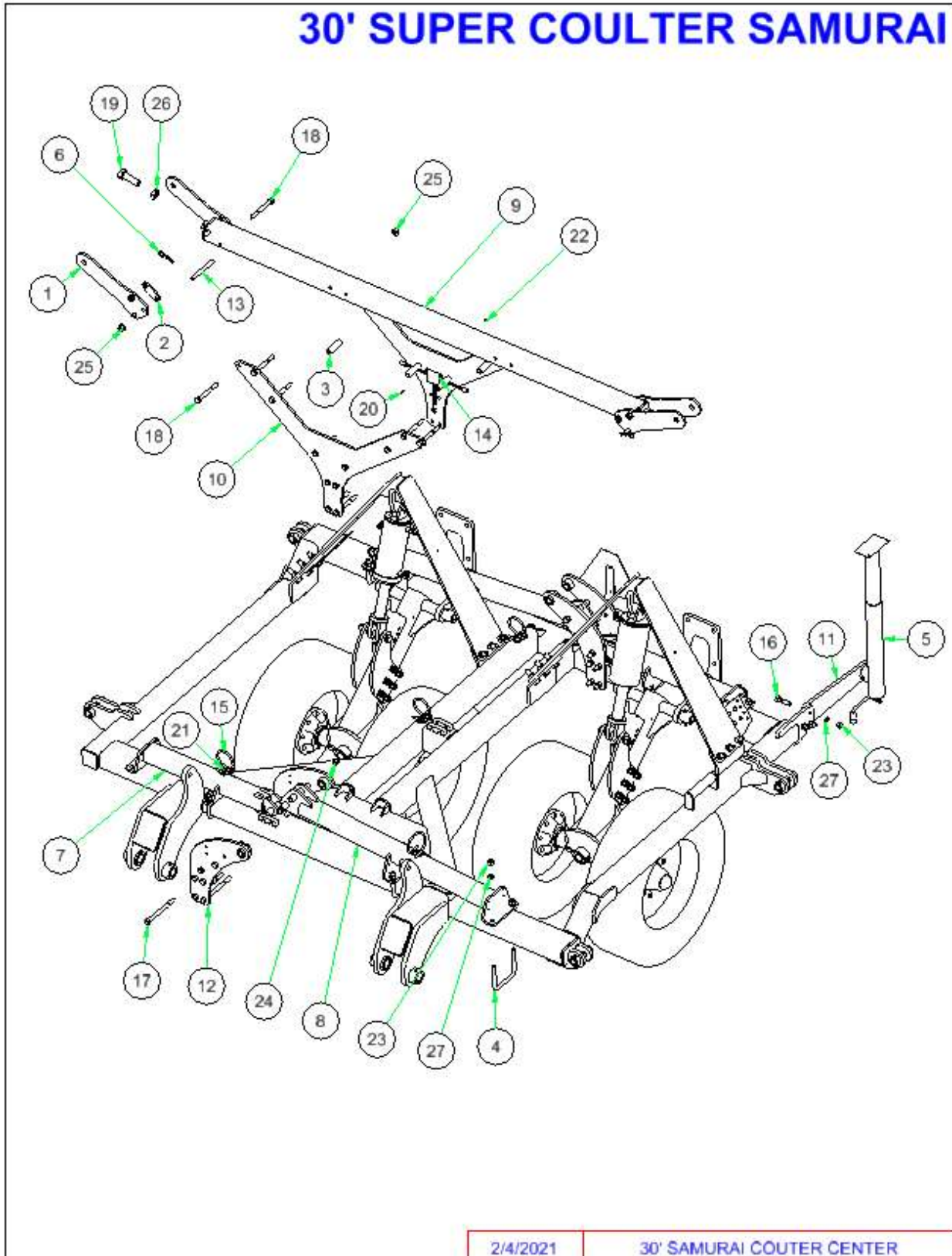

SECTION 4 - PARTS

ITEM	PN	DESCRIPTION
1	8B1215	WING LOCK TAB VRT
2	8B1217	WING LOCK TAB SPCR
3	8B2536	SPACER .76"ID X 4"
4	8C1755	U-BOLT 3/4 X 6-1/16 X 6" SQ
5	8D8523	JACK 8000# DROPLEG 5/8X4.25PIN
6	8D9110	HAIR PIN CLIP LARGE(1"CYL PIN)
7	8J1237	TRUSS CENTER SCS
8	8J1239	TRUSS CENTER SCS
9	8J1241	WING REST TUBE 30' SCS
10	8J1243	TRANSREST MNT PLATE 30' SCS
11	8J1248	JACK SPOOL MNT-REAR
12	8J1277	WINGFOLD CYL ATTACH SCS
13	8K1610	PIN 3/4 X 6 1/4" SAFETYLOCK
14	8K8030A	MODULE AG ENHNCDW/BRAKE6PIN08-
15	8L4702A	CENTER HOSE PROTECTR BRKT
16	8X0114	BOLT 3/4-10NC X 3" GR5 YZ
17	8X0120	BOLT 3/4-10NC X 9" GR5 YZ
18	8X0121	BOLT 3/4-10NC X 6-1/2" GR5 YZ
19	8X0152	BOLT 1-1/4-7NC X 3.75 FULLTHD
20	8X0170	SCREW 8 X .75" FLANGE HD
21	8X0203	NUT 3/8"-16NC SERFLANG GR2 YZ
22	8X0208	NUT 8-32 HEX YZ SER FLNG
23	8X0260	NUT 3/4"-10NC HEX GR2 YZ
24	8X0265	NUT 3/4"-10NC CNTRLOCK GR2 YZ
25	8X0266	NUT 3/4"-10NC SER FLANG GR2 YZ
26	8X0283	NUT JAM 1.25"-7NC GR2 ZDI
27	8X0306	LOCKWASHER 3/4" YLW ZNC

SECTION 4 - PARTS

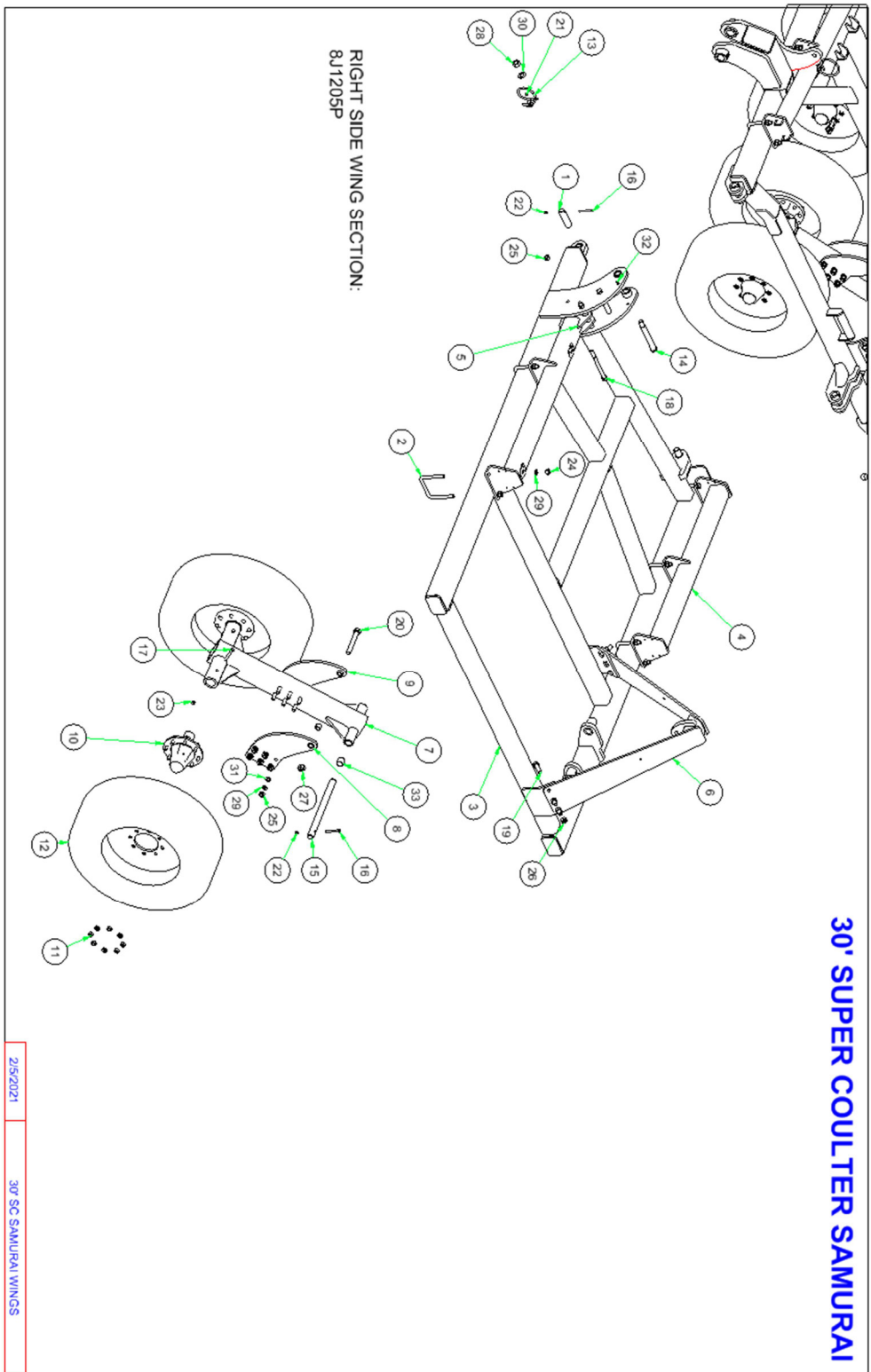

SECTION 4 - PARTS

ITEM	PN	DESCRIPTION
1	8B2025	PIN 1-1/2" X 5.375" YZ
2	8C1755	U-BOLT 3/4 X 6-1/16 X 6" SQ
3	8J1202P	FRAME WING 40' SCS-L
4	8J1232	TRUSS WING FRNT 3 SEC SCS
5	8J1234	TRUSS 3SEC WING CYL ATTCH SCS
6	8J1250	A-FRAME SCS
7	8J1260	LIFTARM RIGID SCS
8	8J1274L	CYL ATTCH VF285 RIGID-L
9	8J1274R	CYL ATTCH VF285 RIGID-R
10	8K1105	812 HUB ASSEMBLY (2.5"RCVR)
11	8K7123	NUT WHEEL BOLT 5/8-18UNF 97-
12	8K7410	285/70R 19.5 ON 19.5X8.25X8WHL
13	8S0700	SPRING, HOSE PROTECTOR LOOP
14	8T3300	PIVOT BOLT CHSLTRP&WNGLFT YZ
15	8T3640	PIN 1-1/2 X 19" HARDENED 98-
16	8X0044	BOLT 7/16-14NC X 3-1/2"GR5 ZDI
17	8X0074	BOLT 1/2-13NC X 4-1/2" GR5 ZDI
18	8X0120	BOLT 3/4-10NC X 9" GR5 YZ
19	8X0133	BOLT 7/8-9NC X 3" GR5 ZDI
20	8X0140	BOLT 1-8NCX7" W/1.5"THDGR5 YZ
21	8X0203	NUT 3/8"-16NC SERFLANG GR2 YZ
22	8X0234	NUT 7/16"-14NC NY-LOCK GR2 ZDI
23	8X0242	NUT 1/2"-13NC NY-LOCK GR2 YZ
24	8X0260	NUT 3/4"-10NC HEX GR2 YZ
25	8X0265	NUT 3/4"-10NC CNTRLOCK GR2 YZ
26	8X0270	NUT 7/8"-9NC CNTRLOCK GR2 YZ
27	8X0281	NUT 1"-8NC NY-LOCK GR2 YZ
28	8X0282	NUT 1"-14TPI TOPLOCK GR B Z
29	8X0306	LOCKWASHER 3/4" YLW ZNC
30	8X0316	WASHER 1" SAE FLAT YZ
31	8X0317	WASHER 3/4" SAE FLAT YZ
32	8X1115	CRG 3/8-16NC X 1-1/2" GR2 ZN
33	8X3130	SLEEVEBRNG 1.656X1.5" ID- 1.5"

SECTION 4 - PARTS

40' SUPERCOUNTER SAMURAI

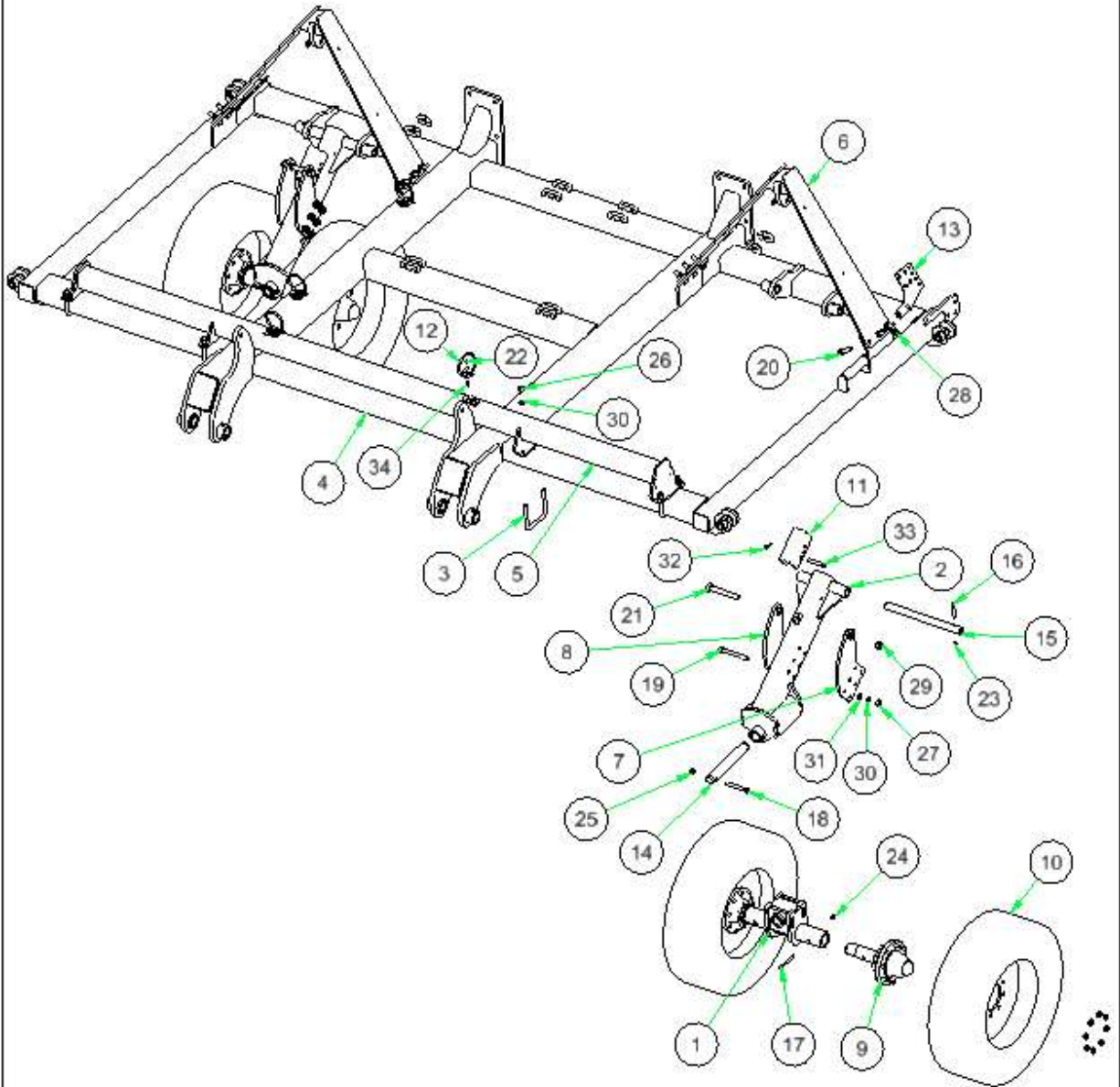

9/18/2020

40' SC SAMURAI CENTER TRANS

SECTION 4 - PARTS

ITEM	PN	DESCRIPTION
1	8B1270B	OSC AXLE SPNDLE HLDR 2.5"
2	8B2540	LIFTARM OSC AXL-RNGD
3	8C1755	U-BOLT 3/4 X 6-1/16 X 6" SQ
4	8J1210P	FRAME CENTER 3 SEC SCS-PTD
5	8J1230	TRUSS CENTER FRNT 3 SEC SCS
6	8J1250	A-FRAME SCS
7	8J1270L	CYL ATTCH VF285 OSC-L
8	8J1270R	CYL ATTCH VF285 OSC-R
9	8K1106	HUB&AXLE ASSY HD817 (2.5"RCVR)
10	8K7410	285/70R 19.5 ON 19.5X8.25X8WHL
11	8K9200	TRNS LCK FRMD 7.5"(2-3/8"ROD)
12	8L4702A	CENTER HOSE PROTECTR BRKT
13	8N0202	BULKHEAD PLATE - A-FRAME
14	8P3910	PIN 2 X 13-1/2" HARDENED
15	8T3640	PIN 1-1/2 X 19" HARDENED 98-
16	8X0044	BOLT 7/16-14NC X 3-1/2"GR5 ZDI
17	8X0074	BOLT 1/2-13NC X 4-1/2" GR5 ZDI
18	8X0095	BOLT 5/8-11NC X 5" GR5 ZDI
19	8X0121A	BOLT 3/4-10NCX6-1/2" -1.38"THD
20	8X0133	BOLT 7/8-9NC X 3" GR5 ZDI
21	8X0140	BOLT 1-8NCX7" W/1.5"THDGR5 YZ
22	8X0203	NUT 3/8"-16NC SERFLANG GR2 YZ
23	8X0234	NUT 7/16"-14NC NY-LOCK GR2 ZDI
24	8X0242	NUT 1/2"-13NC NY-LOCK GR2 YZ
25	8X0253	NUT 5/8"-11NC NY-LOCK GR2 YZ
26	8X0260	NUT 3/4"-10NC HEX GR2 YZ
27	8X0265	NUT 3/4"-10NC CNTRLOCK GR2 YZ
28	8X0270	NUT 7/8"-9NC CNTRLOCK GR2 YZ
29	8X0281	NUT 1"-8NC NY-LOCK GR2 YZ
30	8X0306	LOCKWASHER 3/4" YLW ZNC
31	8X0317	WASHER 3/4" SAE FLAT YZ
32	8X0402	HAIR PIN CLIP 1/8 X 2-9/16"
33	8X0440	CLEVIS PIN 5/8 X 3-7/8" ZDI
34	8X1110	CRG 3/8-16NC X 1" GR2 ZN

SECTION 4 - PARTS

40' SUPER COULTER SAMURAI

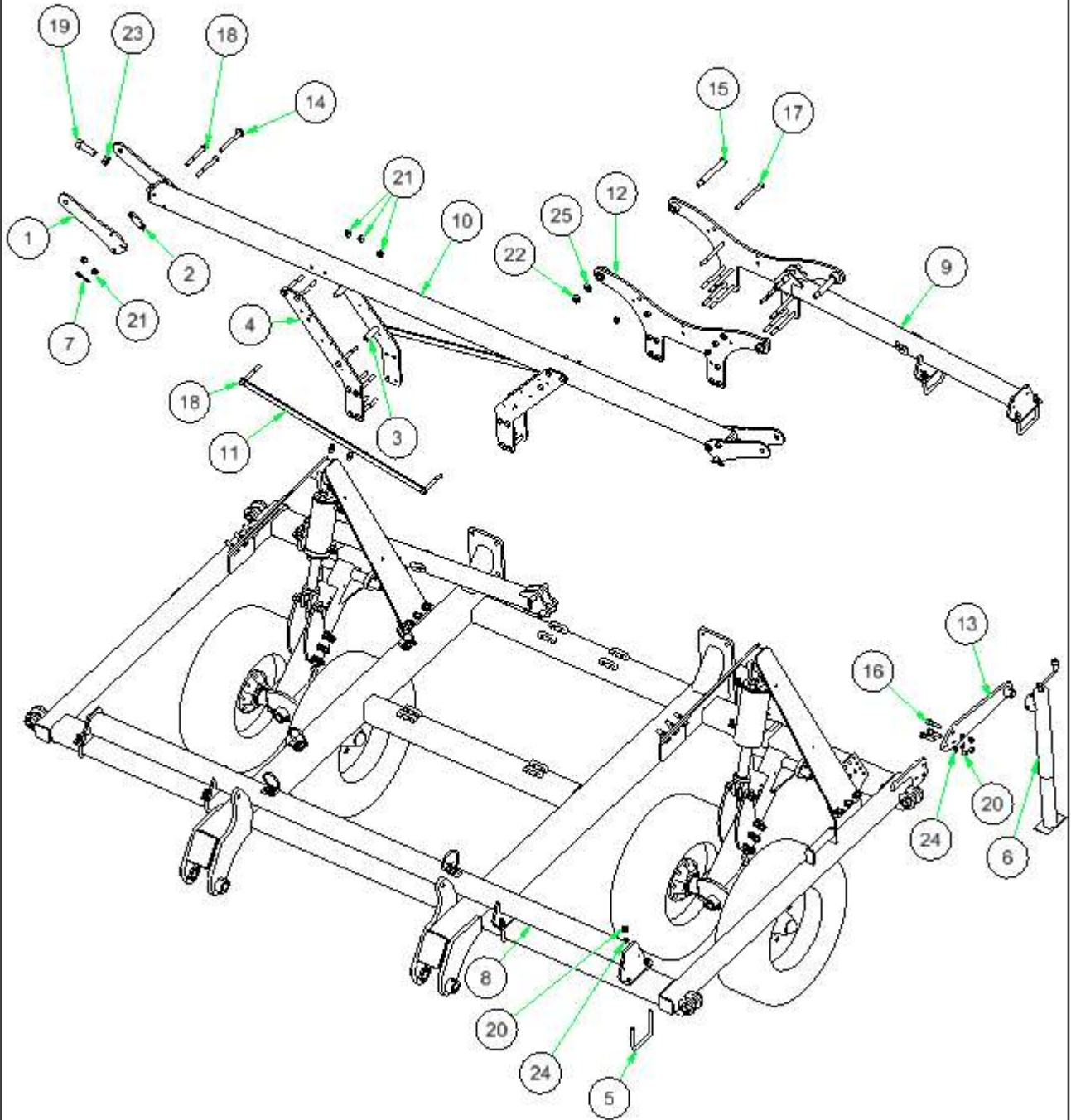

9/17/2020 40' SC SAMURAI CENTER

SECTION 4 - PARTS

ITEM	PN	DESCRIPTION
1	8B1215	WING LOCK TAB VRT
2	8B1217	WING LOCK TAB SPCR
3	8B2536	SPACER .76"ID X 4"
4	8B2560	TRANSREST MNT PLATE
5	8C1755	U-BOLT 3/4 X 6-1/16 X 6" SQ
6	8D8523	JACK 8000# DROPLEG 5/8X4.25PIN
7	8D9110	HAIR PIN CLIP LARGE(1"CYL PIN)
8	8J1230	TRUSS CENTER FRNT 3 SEC SCS
9	8J1236	TRUSS CENTER SCS
10	8J1240	WING REST TUBE SCS
11	8J1242	TRANSREST BRACE SCS
12	8J1246	WINGFOLD CYL ATTACH SCS
13	8J1248	JACK SPOOL MNT-REAR
14	8K1610	PIN 3/4 X 6 1/4" SAFETYLOCK
15	8T3300	PIVOT BOLT CHSLTRP&WNGLFT YZ
16	8X0114	BOLT 3/4-10NC X 3" GR5 YZ
17	8X0120	BOLT 3/4-10NC X 9" GR5 YZ
18	8X0121	BOLT 3/4-10NC X 6-1/2" GR5 YZ
19	8X0152	BOLT 1-1/4-7NC X 3.75 FULLTHD
20	8X0260	NUT 3/4"-10NC HEX GR2 YZ
21	8X0266	NUT 3/4"-10NC SER FLANG GR2 YZ
22	8X0282	NUT 1"-14TPI TOPLOCK GR B Z
23	8X0283	NUT JAM 1.25"-7NC GR2 ZDI
24	8X0306	LOCKWASHER 3/4" YLW ZNC
25	8X0316	WASHER 1" SAE FLAT YZ

SECTION 4 - PARTS

40' SUPER COULTER SAMURAI

RIGHT SIDE WING SECTION:
8J1217P

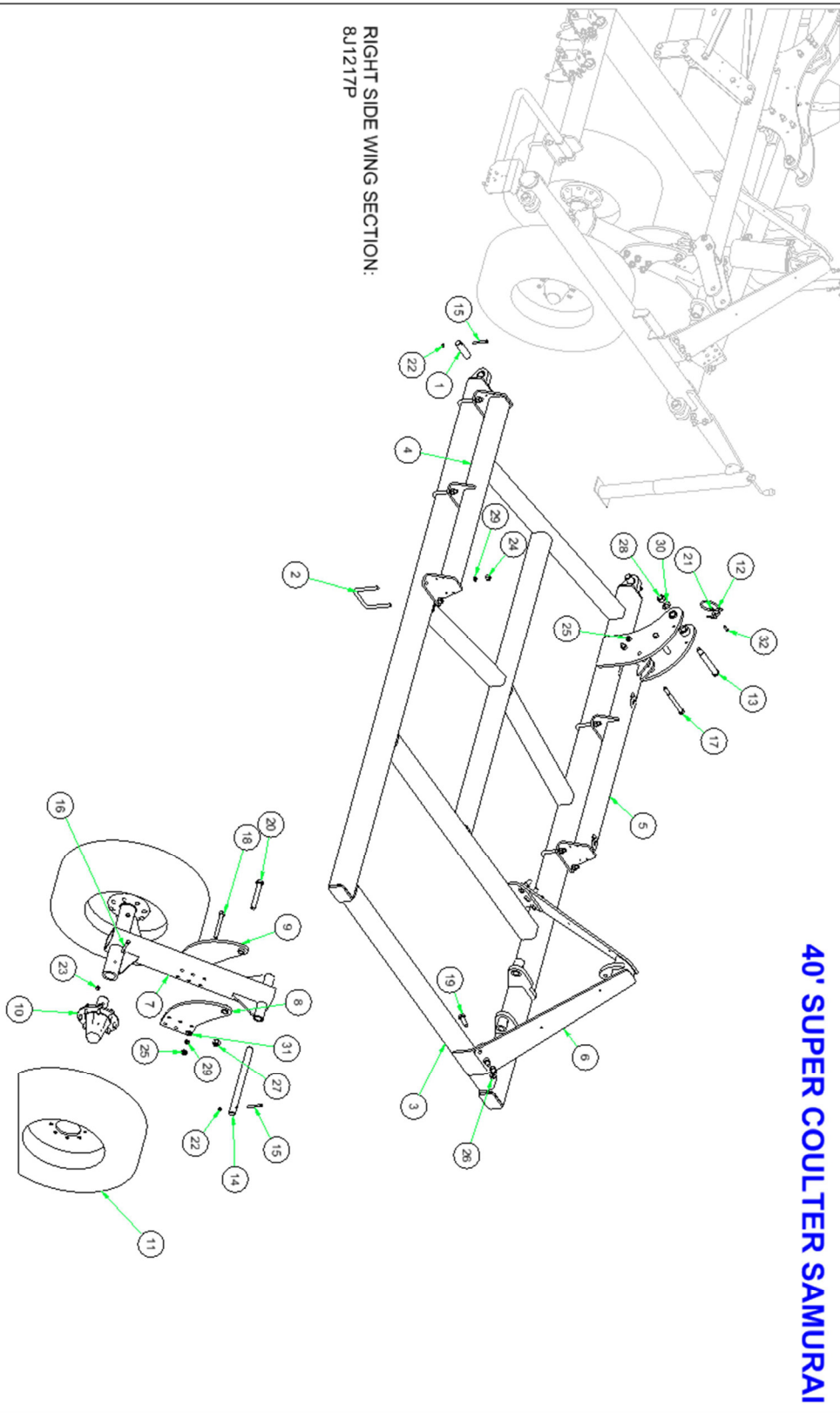

9/17/2020 40' SC SAMURAI WINGS

SECTION 4 - PARTS

ITEM	PN	DESCRIPTION
1	8B2025	PIN 1-1/2" X 5.375" YZ
2	8C1755	U-BOLT 3/4 X 6-1/16 X 6" SQ
3	8J1215P	FRAME WING 40' SCS-L-PTD
4	8J1232	TRUSS WING FRNT 3 SEC SCS
5	8J1234	TRUSS 3SEC WING CYL ATTCH SCS
6	8J1250	A-FRAME SCS
7	8J1260	LIFTARM RIGID SCS
8	8J1274L	CYL ATTCH VF285 RIGID-L
9	8J1274R	CYL ATTCH VF285 RIGID-R
10	8K1105	HUB&AXLE ASSY HD812(2.5"RCVR)
11	8K7410	285/70R 19.5 ON 19.5X8.25X8WHL
12	8L4702A	CENTER HOSE PROTECTR BRKT
13	8T3300	PIVOT BOLT CHSLTRP&WNLFT YZ
14	8T3640	PIN 1-1/2 X 19" HARDENED 98-
15	8X0044	BOLT 7/16-14NC X 3-1/2"GR5 ZDI
16	8X0074	BOLT 1/2-13NC X 4-1/2" GR5 ZDI
17	8X0120	BOLT 3/4-10NC X 9" GR5 YZ
18	8X0121A	BOLT 3/4-10NCX6-1/2" -1.38"THD
19	8X0133	BOLT 7/8-9NC X 3" GR5 ZDI
20	8X0140	BOLT 1-8NCX7" W/1.5"THDGR5 YZ
21	8X0203	NUT 3/8"-16NC SERFLANG GR2 YZ
22	8X0234	NUT 7/16"-14NC NY-LOCK GR2 ZDI
23	8X0242	NUT 1/2"-13NC NY-LOCK GR2 YZ
24	8X0260	NUT 3/4"-10NC HEX GR2 YZ
25	8X0265	NUT 3/4"-10NC CNTRLOCK GR2 YZ
26	8X0270	NUT 7/8"-9NC CNTRLOCK GR2 YZ
27	8X0281	NUT 1"-8NC NY-LOCK GR2 YZ
28	8X0282	NUT 1"-14TPI TOPLOCK GR B Z
29	8X0306	LOCKWASHER 3/4" YLW ZNC
30	8X0316	WASHER 1" SAE FLAT YZ
31	8X0317	WASHER 3/4" SAE FLAT YZ
32	8X1115	CRG 3/8-16NC X 1-1/2" GR2 ZN

SECTION 4 - PARTS

50' SUPERCOUNTER SAMURAI

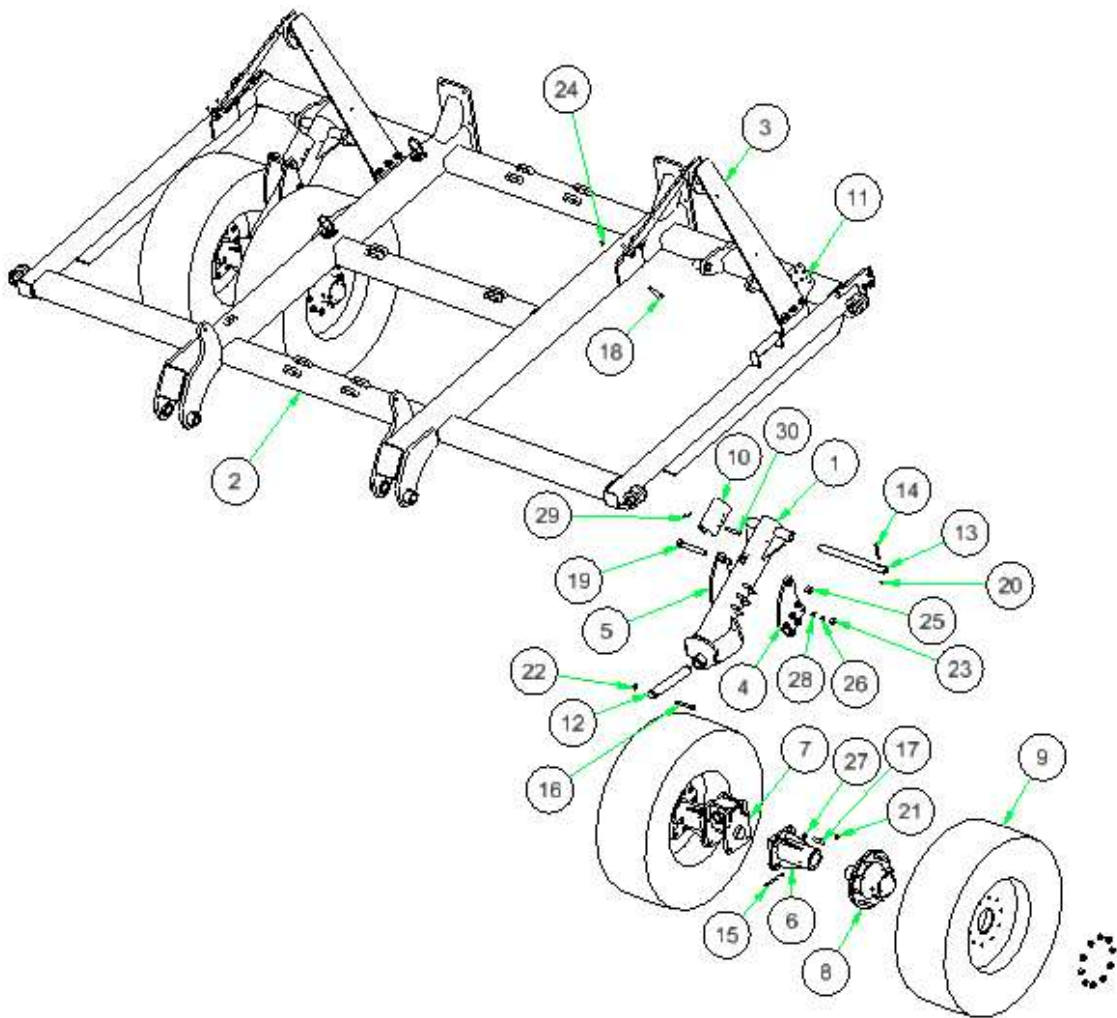

9/21/2020

50' SC SAMURAI CENTER TRANS

SECTION 4 - PARTS

ITEM	PN	DESCRIPTION
1	8B2540	LIFTARM OSC AXL-RNGD
2	8J1212P	8J1212 PAINTED
3	8J1250	A-FRAME SCS
4	8J1272L	CYL ATTCH VF385 OSC-L
5	8J1272R	CYL ATTCH VF385 OSC-R
6	8J4167B	OSC AXLE SPNDLE HLDR 3.375"NRRW
7	8J4168B	OSC AXLE SPNDLE HLDR MNT
8	8K1109	SPINDLE W/H1010 15K
9	8K7540	VF385/65R22.5-22.5X11.75X10WHL
10	8K9200	TRNS LCK FRMD 7.5"(2-3/8"ROD)
11	8N0202	BULKHEAD PLATE - A-FRAME
12	8P3910	PIN 2 X 13-1/2" HARDENED
13	8T3640	PIN 1-1/2 X 19" HARDENED 98-
14	8X0044	BOLT 7/16-14NC X 3-1/2"GR5 ZDI
15	8X0075	BOLT 1/2-13NC X 6" GR5 ZDI
16	8X0095	BOLT 5/8-11NC X 5" GR5 ZDI
17	8X0130	BOLT 7/8-9NC X 2" GR5 ZDI
18	8X0133	BOLT 7/8-9NC X 3" GR5 ZDI
19	8X0140	BOLT 1-8NCX7" W/1.5"THDGR5 YZ
20	8X0234	NUT 7/16"-14NC NY-LOCK GR2 ZDI
21	8X0242	NUT 1/2"-13NC NY-LOCK GR2 YZ
22	8X0253	NUT 5/8"-11NC NY-LOCK GR2 YZ
23	8X0265	NUT 3/4"-10NC CNTRLOCK GR2 YZ
24	8X0270	NUT 7/8"-9NC CNTRLOCK GR2 YZ
25	8X0281	NUT 1"-8NC NY-LOCK GR2 YZ
26	8X0306	LOCKWASHER 3/4" YLW ZNC
27	8X0307	LOCKWASHER 7/8" YLW ZNC
28	8X0317	WASHER 3/4" SAE FLAT YZ
29	8X0402	HAIR PIN CLIP 1/8 X 2-9/16"
30	8X0440	CLEVIS PIN 5/8 X 3-7/8" ZDI

SECTION 4 - PARTS

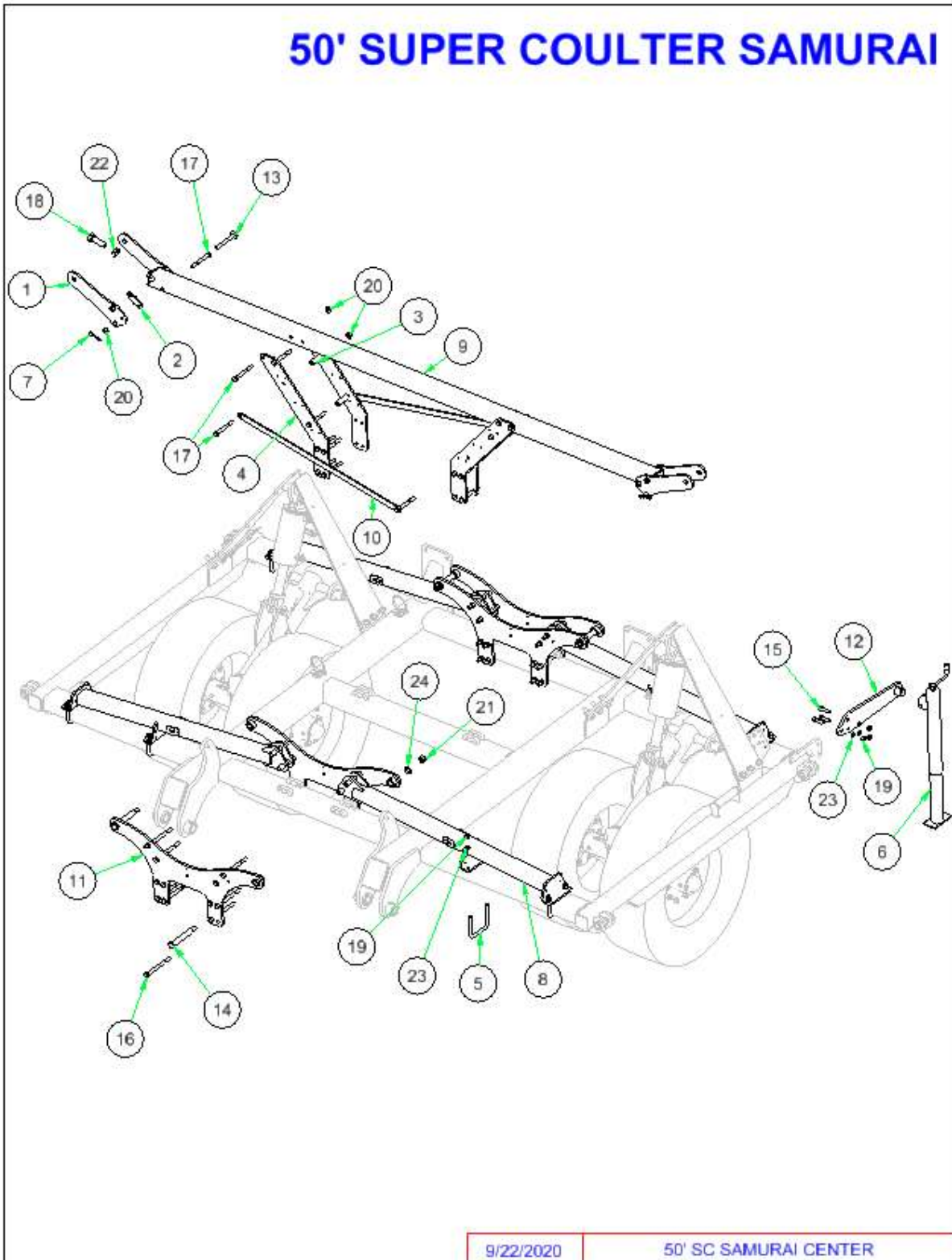

SECTION 4 - PARTS

ITEM	PN	DESCRIPTION
1	8B1215	WING LOCK TAB VRT
2	8B1217	WING LOCK TAB SPCR
3	8B2536	SPACER .76"ID X 4"
4	8B2560	TRANSREST MNT PLATE
5	8C1755	U-BOLT 3/4 X 6-1/16 X 6" SQ
6	8D8523	JACK 8000# DROPLEG 5/8X4.25PIN
7	8D9110	HAIR PIN CLIP LARGE(1"CYL PIN)
8	8J1236	TRUSS CENTER SCS
9	8J1240	WING REST TUBE SCS
10	8J1242	TRANSREST BRACE SCS
11	8J1246	WINGFOLD CYL ATTACH SCS
12	8J1248	JACK SPOOL MNT-REAR
13	8K1610	PIN 3/4 X 6 1/4" SAFETYLOCK
14	8T3300	PIVOT BOLT CHSLTRP&WNGLFT YZ
15	8X0111	BOLT 3/4-10NC X 2-1/2" GR5 YZ
16	8X0120	BOLT 3/4-10NC X 9" GR5 YZ
17	8X0121	BOLT 3/4-10NC X 6-1/2" GR5 YZ
18	8X0152	BOLT 1-1/4-7NC X 3.75 FULLTHD
19	8X0260	NUT 3/4"-10NC HEX GR2 YZ
20	8X0266	NUT 3/4"-10NC SER FLANG GR2 YZ
21	8X0282	NUT 1"-14TPI TOPLOCK GR B Z
22	8X0283	NUT JAM 1.25"-7NC GR2 ZDI
23	8X0306	LOCKWASHER 3/4" YLW ZNC
24	8X0316	WASHER 1" SAE FLAT YZ

SECTION 4 - PARTS

50' SUPER COULTER SAMURAI

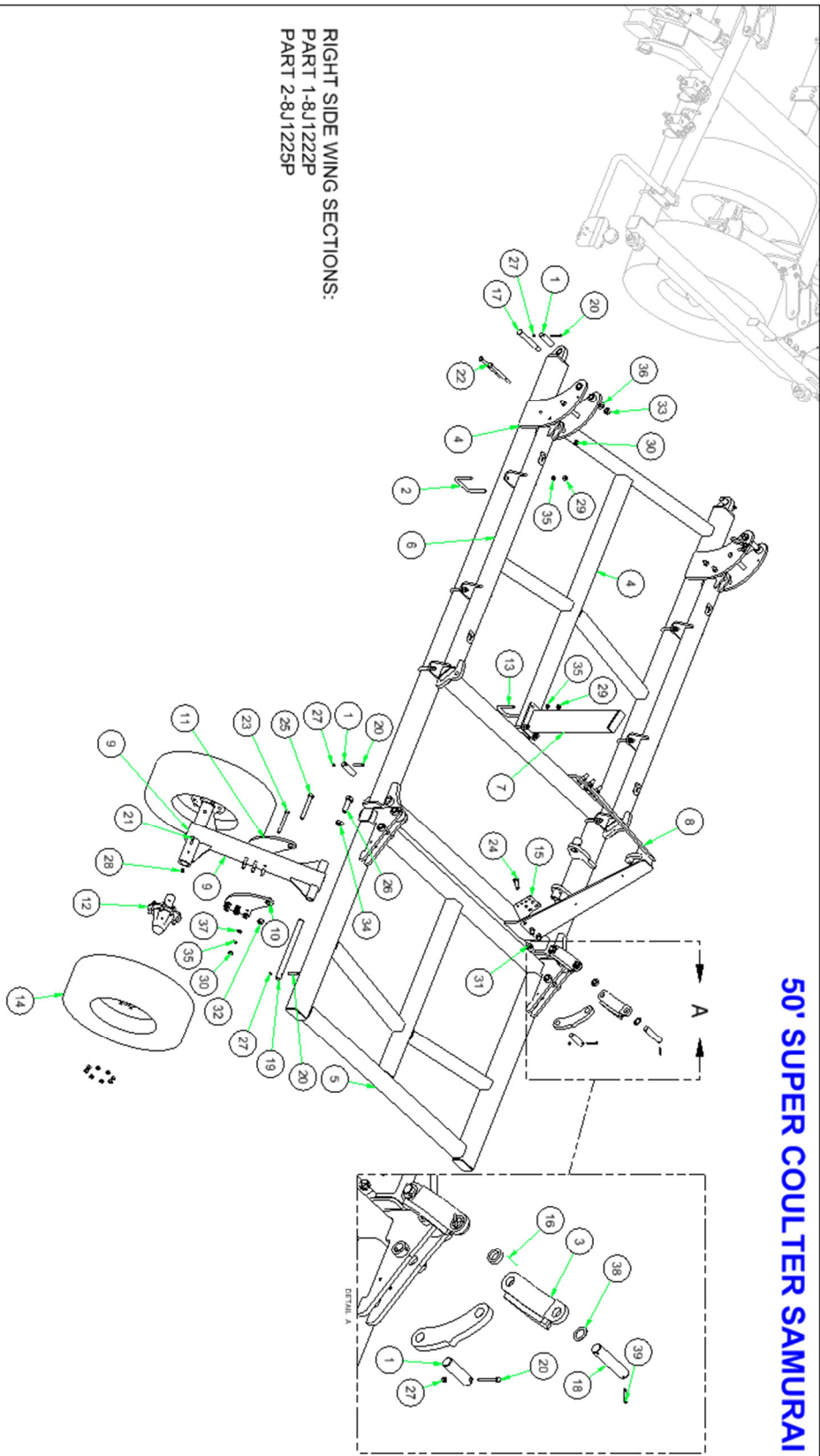

9/22/2020

50' SC SAMURAI WINGS

SECTION 4 - PARTS

ITEM	PN	DESCRIPTION
1	8B2025	PIN 1-1/2" X 5.375" YZ
2	8C1755	U-BOLT 3/4 X 6-1/16 X 6" SQ
3	8J0920	LINK PT 1 TO 2 HI-CLRNCE
4	8J1220P	8J1220 PAINTED
5	8J1225P	8J1225 PAINTED
6	8J1238	TRUSS WING 5 SEC SCS
7	8J1244	WING REST PT2 SCS
8	8J1250	A-FRAME SCS
9	8J1260	LIFTARM RIGID SCS
10	8J1274L	CYL ATTCH VF285 RIGID-L
11	8J1274R	CYL ATTCH VF285 RIGID-R
12	8K1105	HUB&AXLE ASSY HD812(2.5"RCVR)
13	8K5515	U-BOLT 3/4 X 4-1/16 X 6" SQ
14	8K7410	285/70R 19.5 ON 19.5X8.25X8WHL
15	8N0202	BULKHEAD PLATE - A-FRAME
16	8T2514	SPACER PART 1 TO 2 LINK
17	8T3300	PIVOT BOLT CHSLTRP&WNLFT YZ
18	8T3608	PIN HARDENED
19	8T3640	PIN 1-1/2 X 19" HARDENED 98-
20	8X0044	BOLT 7/16-14NC X 3-1/2"GR5 ZDI
21	8X0074	BOLT 1/2-13NC X 4-1/2" GR5 ZDI
22	8X0120	BOLT 3/4-10NC X 9" GR5 YZ
23	8X0121A	BOLT 3/4-10NCX6-1/2" -1.38"THD
24	8X0133	BOLT 7/8-9NC X 3" GR5 ZDI
25	8X0140	BOLT 1-8NCX7" W/1.5"THDGR5 YZ
26	8X0152	BOLT 1-1/4-7NC X 3.75 FULLTHD
27	8X0234	NUT 7/16"-14NC NY-LOCK GR2 ZDI
28	8X0242	NUT 1/2"-13NC NY-LOCK GR2 YZ
29	8X0260	NUT 3/4"-10NC HEX GR2 YZ
30	8X0265	NUT 3/4"-10NC CNTRLOCK GR2 YZ
31	8X0270	NUT 7/8"-9NC CNTRLOCK GR2 YZ
32	8X0281	NUT 1"-8NC NY-LOCK GR2 YZ
33	8X0282	NUT 1"-14TPI TOPLOCK GR B Z
34	8X0283	NUT JAM 1.25"-7NC GR2 ZDI
35	8X0306	LOCKWASHER 3/4" YLW ZNC
36	8X0316	WASHER 1" SAE FLAT YZ
37	8X0317	WASHER 3/4" SAE FLAT YZ
38	8X0354	WASHER 1-1/2"IDX2.25"X14GA YZ
39	8X0523	ROLL PIN 5/16 X 2-1/2" PLN

SECTION 4 - PARTS

40-50' SAMURAI COULTER

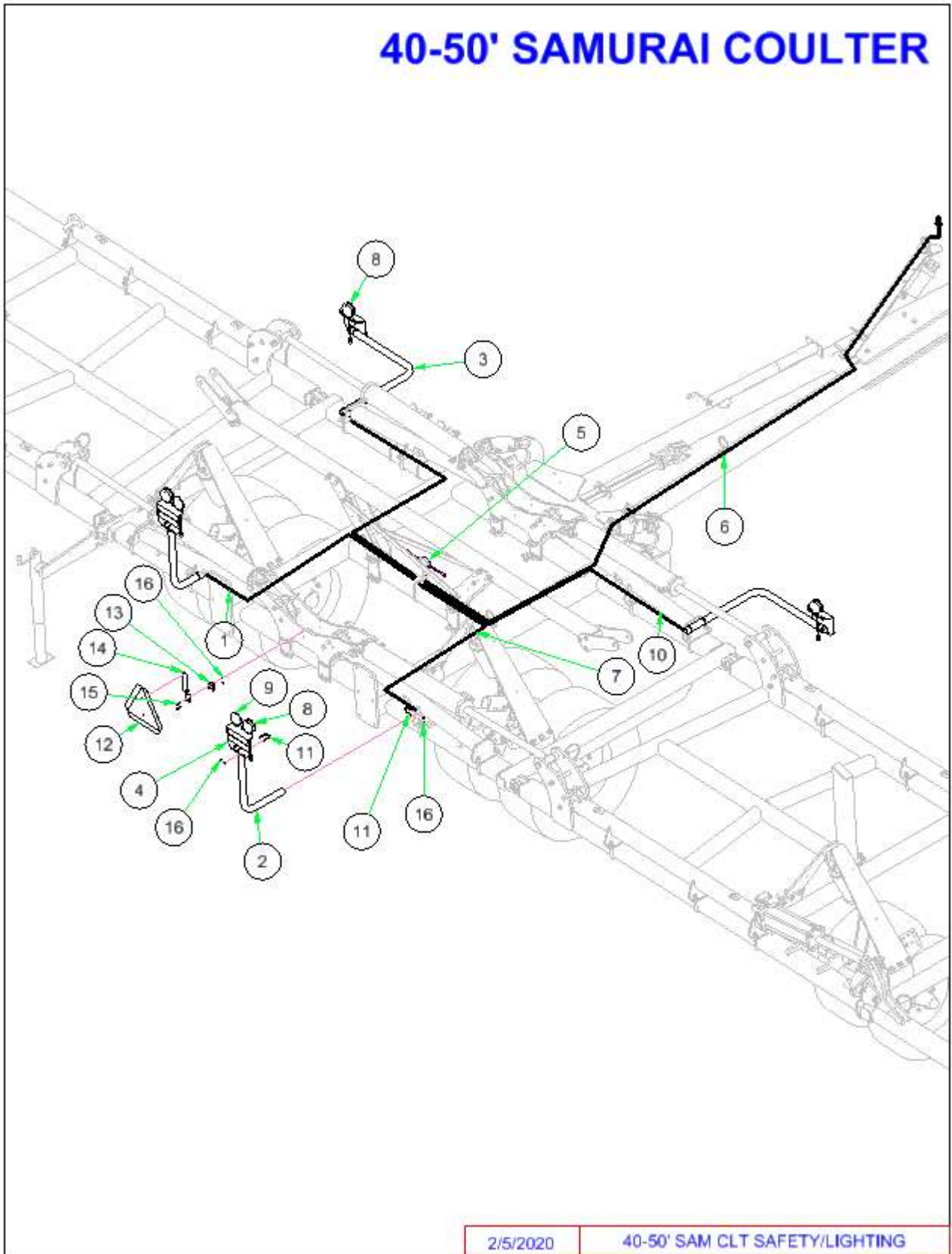

SECTION 4 - PARTS

ITEM	PN	DESCRIPTION
1	8J1212P	8J1212 PAINTED
2	8K8005	TUBE LGHT BRKT SHRT 1.5SQ PNTD
3	8K8010	TUBE LGHT BRCKT1.5SQ55.5"00-
4	8K8020	MOUNTNG BRCKT LIGHT 00-
5	8K8030A	MODULE AG ENHNCDW/BRAKE6PIN08-
6	8K8071	MAIN HRNSS 7PN 26' W/BRAKE
7	8K8076	EXT HARNESS 12' DEUTSCH
8	8K8090B	LIGHT LED AMBER 2WR DTSCH 12-
9	8K8095B	LIGHT LED RED 3WIRE DTSCH 12-
10	8K8104	EXT HARNESS 13'2WIRE DTSCH
11	8L0258	U-BOLT 5/16 X 1-1/2 X 2-1/2"SQ
12	8S1120	SIGN SLOW MOVING VEHICLE(SMV)
13	8S1124	MOUNTING SOCKET SMV SIGN ZDI
14	8S1126	MNT SPADE W/HRDWR SMV SIGN
15	8X0021B	BOLT 5/16-18NC X 1-1/4"GR5 YZ
16	8X0211	NUT 5/16"-18NC SERFLANG GR2 YZ

SECTION 4 - PARTS

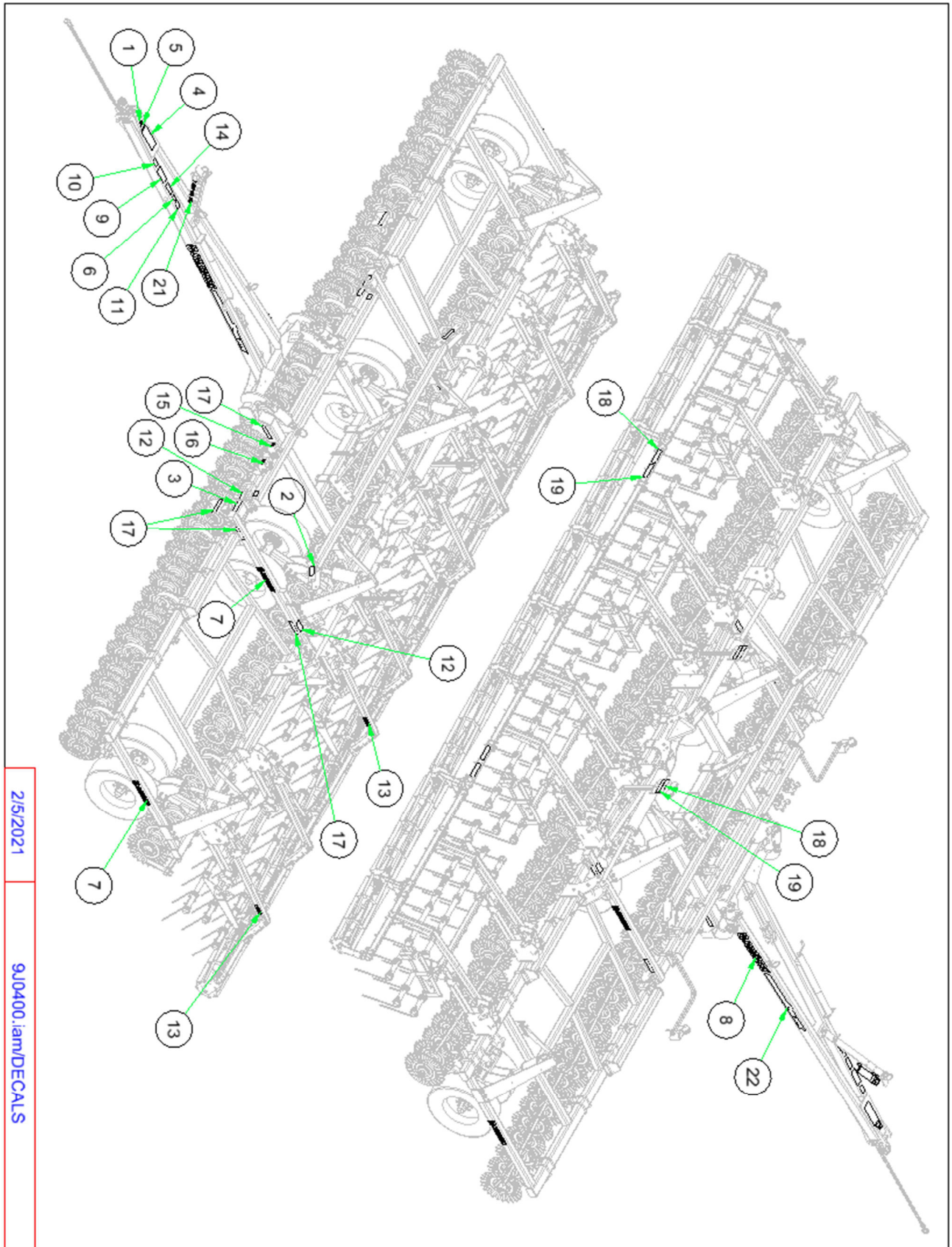

2/5/2021

9J0400.iam/DECALS

SECTION 4 - PARTS

ITEM	PN	DESCRIPTION
1	8Z0052	PATENT DECAL
2	8Z0075	TRANSPORT LOCK DECAL
3	8Z0087	DECAL"WARNING"PINCH POINT03-
4	8Z0099	"WARNING" JACK DECAL
5	8Z0100	MADE IN THE USA DECAL
6	8Z0102	DECAL"IMPORTANT" REAR JACK(S)
7	8Z0202	3.5" SUMMERS DECAL
8	8Z0204	5.5" SUMMERS DECAL
9	8Z0276	GENERAL MACHINE CAUTION DECAL
10	8Z0340	REPHASING CYLINDERS DECAL
11	8Z0342	INSTALL CYL LOCKS DECAL
12	8Z0344	DECAL WING DANGER
13	8Z0345	DECAL - DANGER HYD BSKT
14	8Z0346	ELECTROCUTION-TILLAGE EQUIP. DECAL
15	8Z0502	DECAL WING PRESSURE
16	8Z0503	DECAL BSKT PRESSURE
17	8Z0800	REFLECTOR AMBER ADHSVBCK98-
18	8Z0805	REFLCTR REDORANGE ADHSVBK99-
19	8Z0810	REFLECTOR RED ADHSV-BACK 98-
20	8Z1010	MANUAL HOLDER TUBE
21	8Z2534	DECAL LIFT-AUX-WING-BSKT
22	8Z2560	DECAL 4.5 X 42.2" SC SAMURAI

SECTION 4 - PARTS

SUPER COULTER SAMURAI GANGS

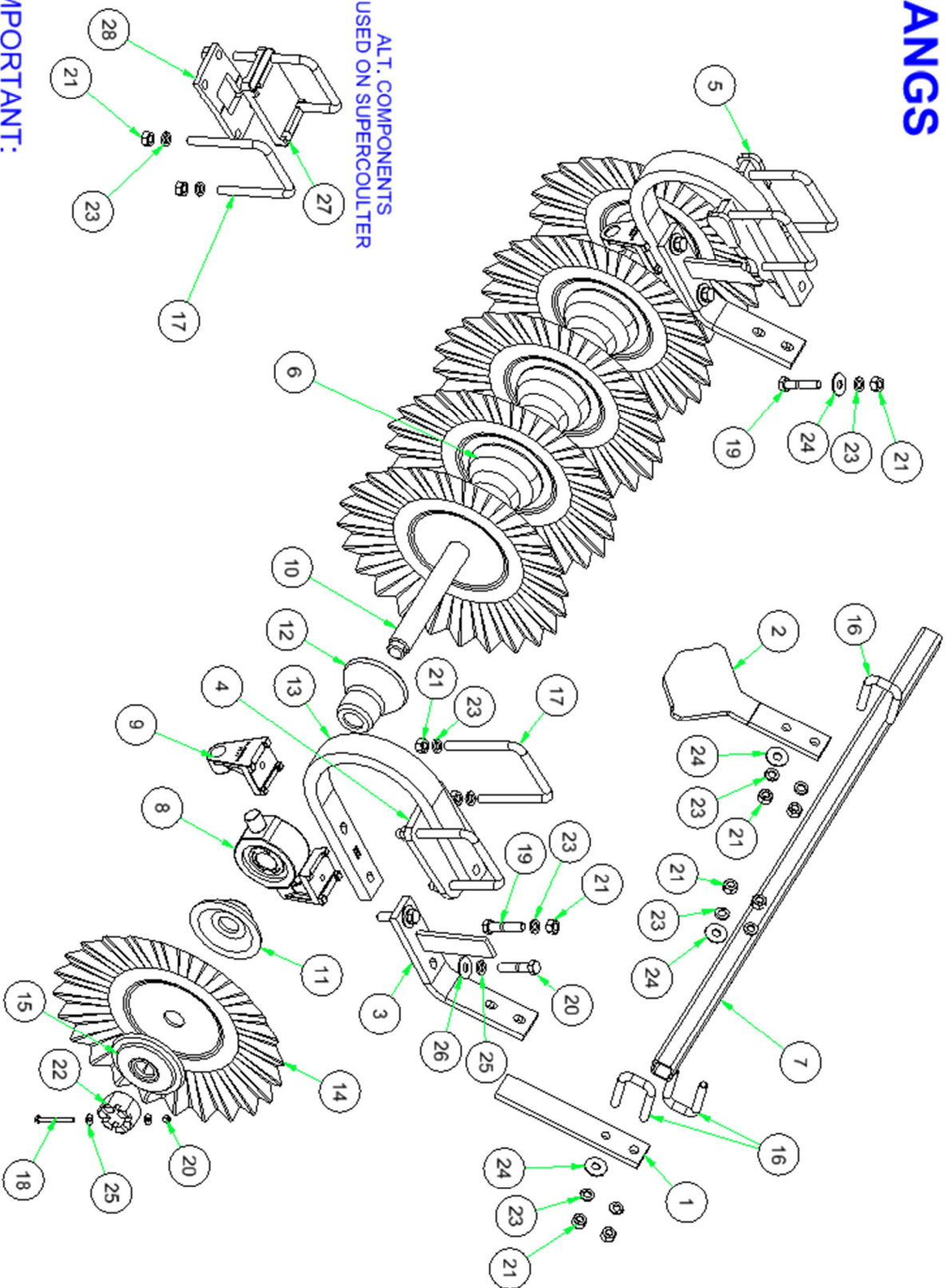

ALT. COMPONENTS
USED ON SUPERCOULTER

IMPORTANT:

MAINTAIN GANG TORQUE AT 1200 FT-LB

8/26/2022

6BLADE GANGGANG PARTS
ASSY-R1am7

SECTION 4 - PARTS

ITEM	PN	DESCRIPTION
1	8J0190	SCRAPER FLAT SUPRCOULTR 00-
2	8J0192	SCRAPER CASTSPOOL SUPRCLTR
3	8J0200	MNT FLAT SCRAPER SPRCLTR
4	8J1290B	C-SHANK MNT-PIVOT
5	8J1295	C-SHANK MNT-1-5 DEGREE
6	8J3010	CAST SPOOL 10" FULL CLTR 00-
7	8J3256	SCRAPER MNT TUBE-56"SCLTR00-
	8J3276	SCRAPER MNT TUBE-76"SCLTR00-
8	8K2060	GANG BRNG W/HOUSING
9	8K2060	GANG BRNG W/HOUSING
10	8K2130	GANG ROD 2" DIA X 57"
	8K2150	GANG ROD 2" DIA X 77"
11	8K4008	CAST SPOOL HALF SHORT
12	8K4018	CAST SPOOL HALF LONG
13	8K4400	SPRING SHANK GNG MNT 2.5"X1.25
14	8K5022SM	BLADE DSK1/4X22" 2HL SAMURAI
15	8K5200	WASHER GANG BOLT 2.03" ID
16	8K5505	U-BOLT 3/4 X 2-1/8 X 4-1/4" SQ
17	8K5520	U-BOLT 3/4 X 6-1/8 X 7-1/2" SQ
18	8X0015	BOLT 3/8-16NC X 3-3/4" GR5 YZ
19	8X0115	BOLT 3/4-10NC X 3-1/2" GR5 YZ
20	8X0202	NUT 3/8"-16NC NY-LOCK GR2 YZ
21	8X0260	NUT 3/4"-10NC HEX GR2 YZ
22	8X0292	NUT 2"-4.5 HVY HEXSLOT GR2 PLN
23	8X0306	LOCKWASHER 3/4" YLW ZNC
24	8X0318	WASHER 3/4"(13/16"ID)FLAT YZ
25	8X0320	WASHER 3/8"(7/16" ID)FLAT YZ
26	8X0325	WASHER 3/4"(13/16"ID)FLAT PLN
27	8K4200	CLAMP GANGMNT W/PEG CAST PNTD
28	8K4210	CLAMP GANG MOUNT CAST PNTD

SECTION 4 - PARTS

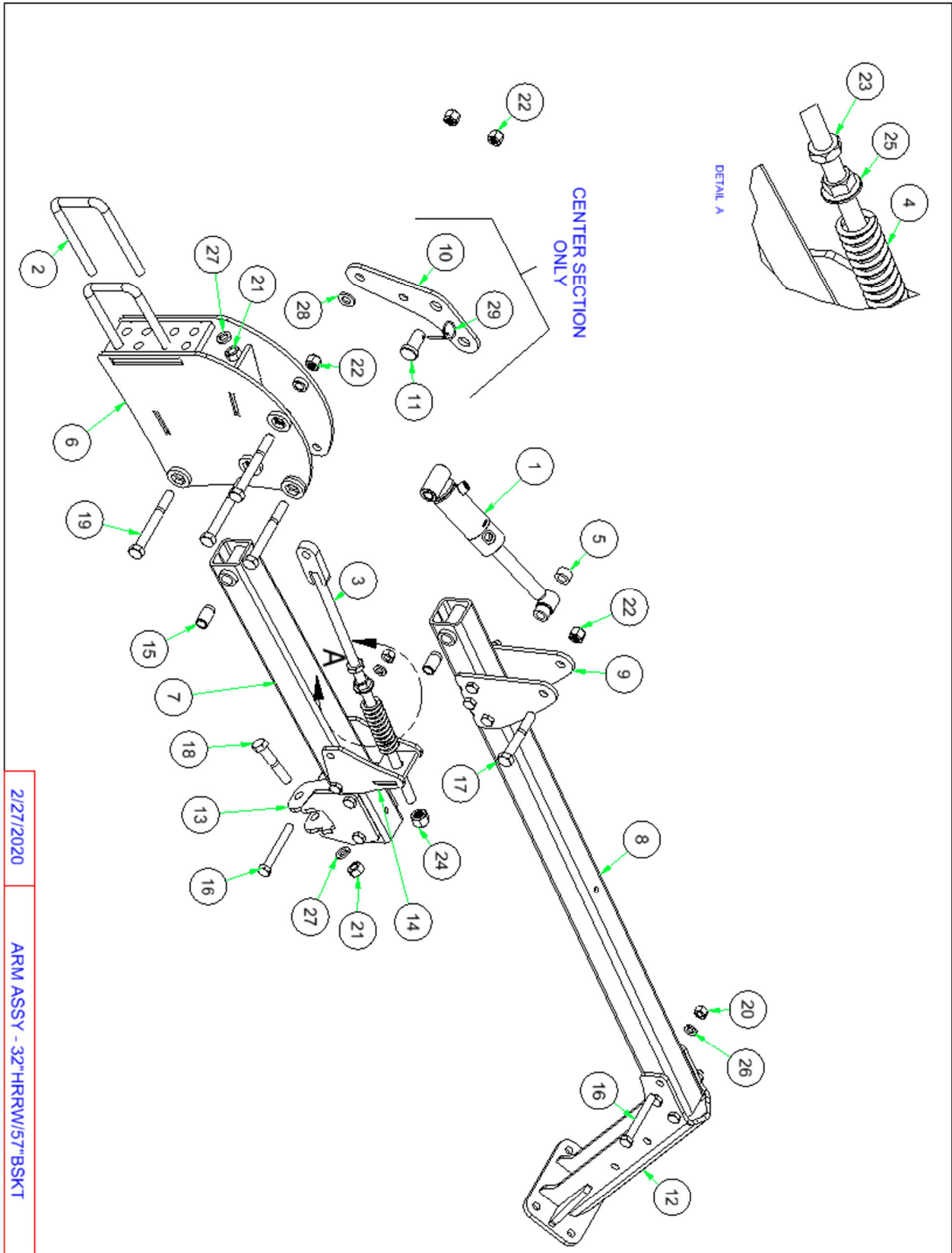

2/27/2020

ARM ASSY - 32" HRRW/57" BSKT

SECTION 4 - PARTS

ITEM	PN	DESCRIPTION
1	8B2175	HYD CYL 2.0 X 1.75" HYD BSKT
2	8D0340	U-BOLT 3/4 X 4-1/16 X 7-3/4" SQ
3	8H1290	BOLT-SPRINGROD 7/8" X 29"
4	8H1295	SPRING-COMP - 1.71"ODX7"X.262"
5	8H2005	CYLINDER SPACER
6	8H3000B	MNT HEAD HRRW/HYD BSKT
7	8H3010	ARM, HRRW- 32"
8	8H3020	ARM, BSKT- 57"
9	8H3021S	CYL ATTCH-HYD BSKT ARM-SCS
10	8H3025	STL 3/8 X 9 5/8 - 9 7/8"
11	8H3028	PIN 1" X 2.375"
12	8H3030	RLLNG BSKT ATTCH ARM
13	8H3032	HRRW ATTCH CLAMP
14	8H3033	HRRW SPRINGROD ATTCH
15	8W1897	BUSHING
16	8X0095	BOLT 5/8-11NC X 5" GR5 ZDI
17	8X0113	BOLT 3/4-10NC X 5" GR5 YZ
18	8X0118	BOLT 3/4-10NC X 4" GR5 ZDI
19	8X0121	BOLT 3/4-10NC X 6-1/2" GR5 YZ
20	8X0250	NUT 5/8"-11NC HEX GR2 YZ
21	8X0260	NUT 3/4"-10NC HEX GR2 YZ
22	8X0261	NUT 3/4"-10NC NY-LOCK GR2 YZ
23	8X0269	NUT 7/8"-9NC JAM GR2 ZDI
24	8X0271	NUT 7/8"-9NC NY-LOCK GR2 YZ
25	8X0274	NUT 7/8"-9NC SERFLANG GR2 YZ
26	8X0304	LOCKWASHER 5/8" YLW ZNC
27	8X0306	LOCKWASHER 3/4" YLW ZNC
28	8X0317	WASHER 3/4" SAE FLAT YZ
29	8X0492	LYNCH PIN 3/16 X 1-1/4" YZ

SECTION 4 - PARTS

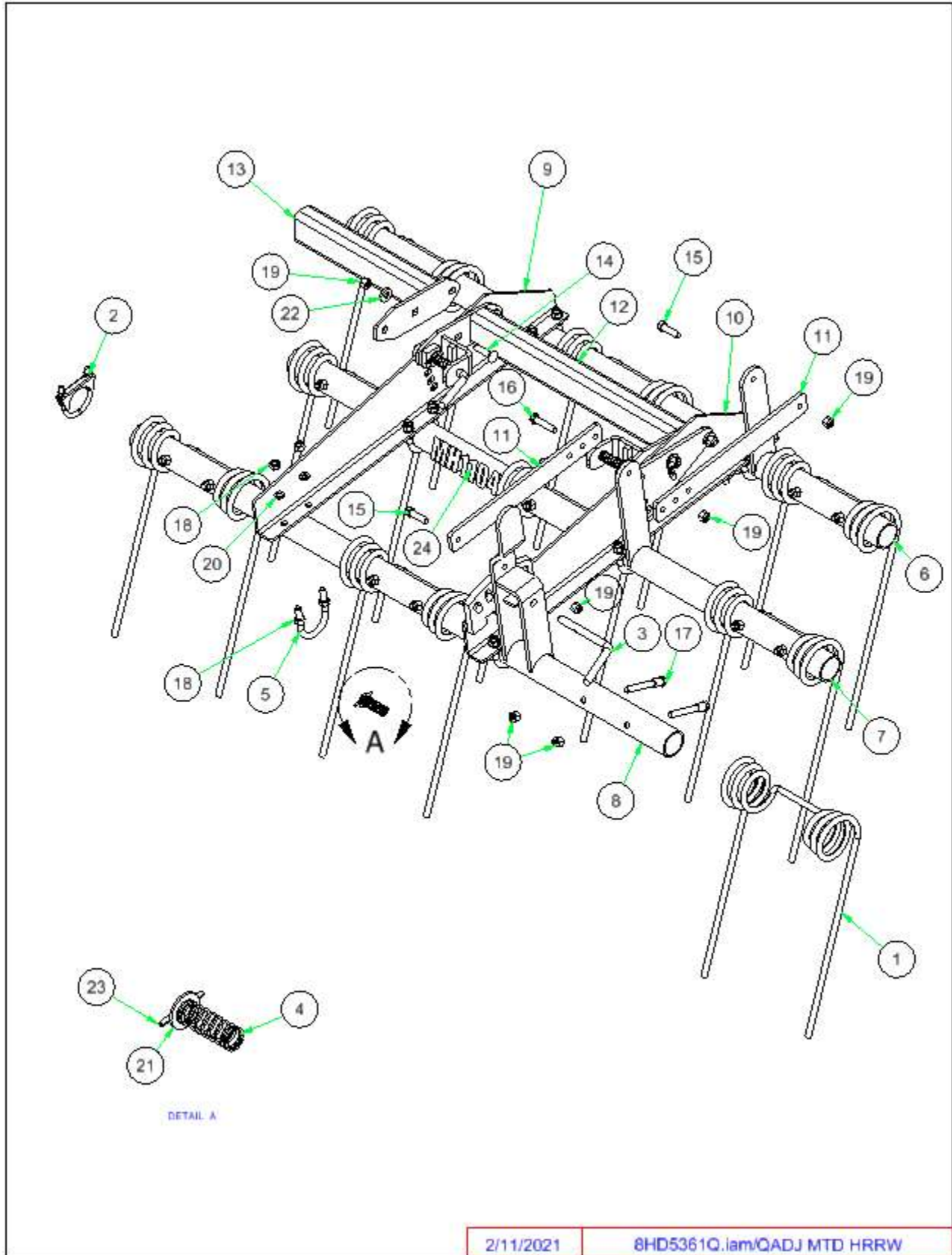

SECTION 4 - PARTS

ITEM	PN	DESCRIPTION
1	8H1180S	HARROW TOOTH 1/2 X 20" M104/SH
2	8HD0080	PIPE CLAMP 2-1/2"ID PLATED ZDI
3	8HD0150	PIN
4	8HD0160	COMPRESSION SPRING
5	8HD0200	U-BOLT 1/2 X 2-3/8 X 3-9/16" RND
6	8HD5052	1ST PIPE W/LVR 6' 3OR4BR
	8HD5072	1ST PIPE W/LVR 8' 104/6 3OR4BR
	8HD5082	1ST PIPE W/LVR10' 104/6 3OR4BR
7	8HD5054	2ND PIPE W/LVR 6' 3OR4BR
	8HD5074	2ND PIPE W/LVR 8' 104/6 3OR4BR
	8HD5084	2ND PIPE W/LVR10' 104/6 3OR4BR
8	8HD5056Q	3RD PIPE/LVR6' 3BR104/6QADJ
	8HD5076Q	3RD PIP/LVR8' 3BR104/6 QADJ00-
	8HD5086Q	3RDPIP/LVR10' 3BR104/6 QADJ00-
9	8HD5111	SIDE PLT 1/4"3BR QADJ LEFT
10	8HD5112	SIDE PLT 1/4"3BR QADJ RGHT
11	8HD5115	ADJUSTABLE CONNECTING BAR
12	8HD5141	CROSS TUBE W/FLATS 6' QADJ
	8HD5151	CROSS TUBE W/FLATS 8' QADJ13-
	8HD5161	CROSS TUBE W/FLATS 10' QADJ13-
13	8HD5181	EXT BRKT QADJ 2ND ARM 15"
14	8X0065	CRG 1/2-13NC X 2" GR5 ZDI
15	8X0066	BOLT 1/2-13NC X 1-3/4" GR5 ZDI
16	8X0067	BOLT 1/2-13NC X 2-1/4" GR5 ZDI
17	8X0079	BOLT 1/2-13X4-1/8"SHOULDR GR2ZDI
18	8X0240	NUT 1/2"-13NC HEX GR2 YZ
19	8X0242	NUT 1/2"-13NC NY-LOCK GR2 YZ
20	8X0303	LOCKWASHER 1/2" YLW ZNC
21	8X0323	WASHER 5/8" SAE FLAT YZ
22	8X0330	WASHER 17/32"ID X 1.25"OD YZ
23	8X0520	ROLL PIN 3/16 X 2" ZINC CLEAR
24	8Z0114	MH1104 DECAL

SECTION 4 - PARTS

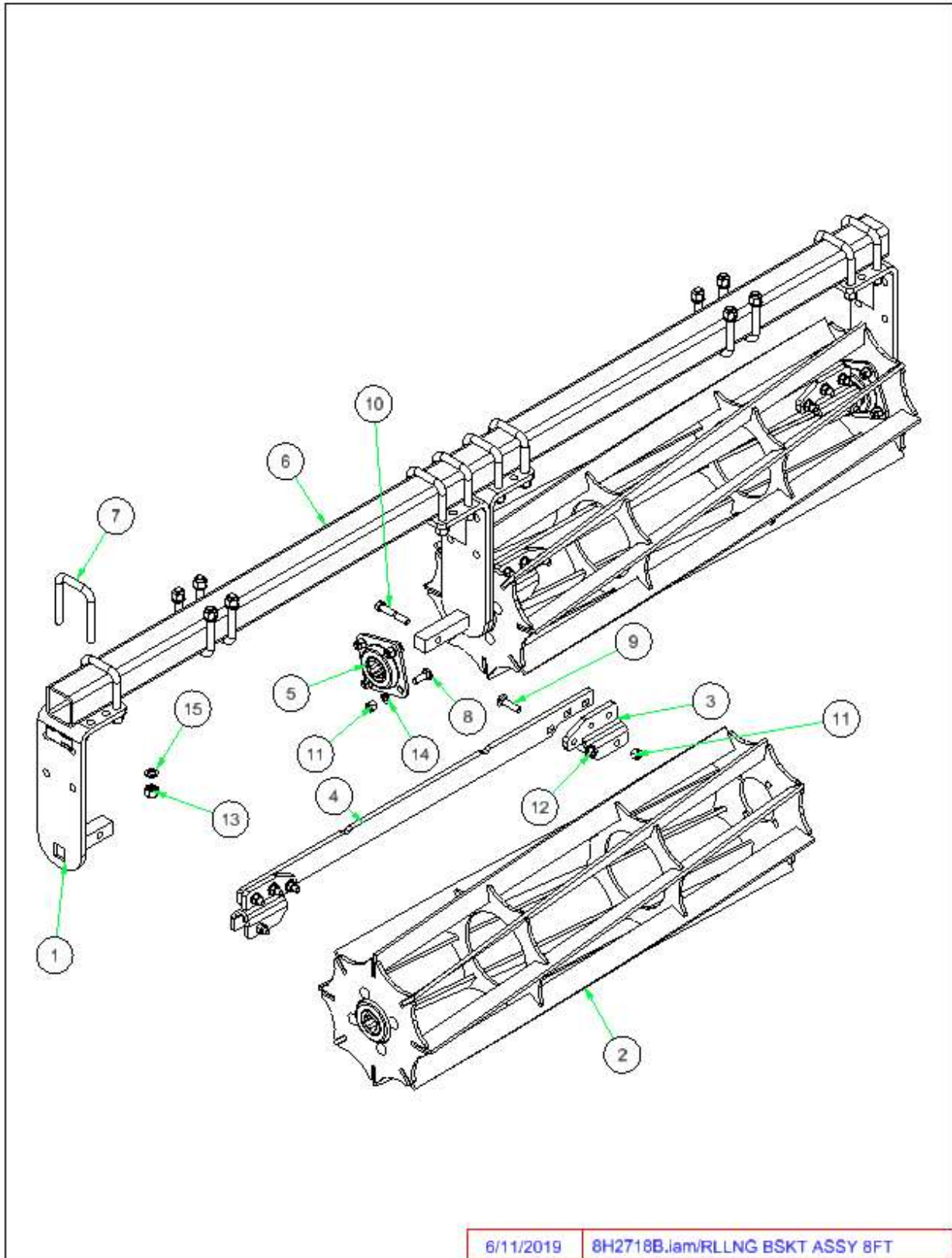

SECTION 4 - PARTS

ITEM	PN	DESCRIPTION
1	8H2601B	RLLNG BSKT ENDPLATE 4SCRPR
2	8H2634	RLLNG BSKT 4' REEL ONLY
	8H2636	RLLNG BSKT 6' REEL ONLY
3	8H2660B	RLLING BSKT SCRAPER MNT
4	8H2664	4' BSKT SCRAPER (40.5")
	8H2666	6' BSKT SCRAPER (63.5")
5	8H2703	BEARING 1-1/4" SQ FLNG4BLT
6	8H2706	TUBE SQ 3 X 4T- 70" BSKT MNT
	8H2708	TUBE SQ 3 X 4T- 94" BSKT MNT
	8H2710	TUBE SQ 3 X 4T- 118" BSKT MNT
7	8S0358	U-BOLT 5/8 X 3-1/16 X 4-1/2" SQ.
8	8X0064	CRG 1/2-13NC X 1-1/2" GR5 YZ
9	8X0065	CRG 1/2-13NC X 2" GR5 ZDI
10	8X0069	BOLT 1/2-13NC X 3" GR5 ZDI
11	8X0242	NUT 1/2"-13NC NY-LOCK GR2 YZ
12	8X0244	NUT 1/2"-13NC FLANG TOP LOCK Z
13	8X0253	NUT 5/8"-11NC NY-LOCK GR2 YZ
14	8X0303	LOCKWASHER 1/2" YLW ZNC
15	8X0304	LOCKWASHER 5/8" YLW ZNC
16	8Z0046	PATENT PENDING DECAL

SECTION 4 - PARTS

8K1100

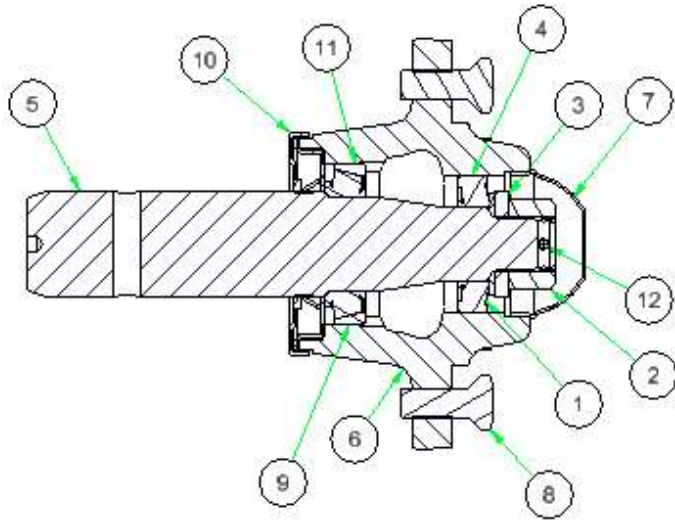

**8K1105
8K1105S**

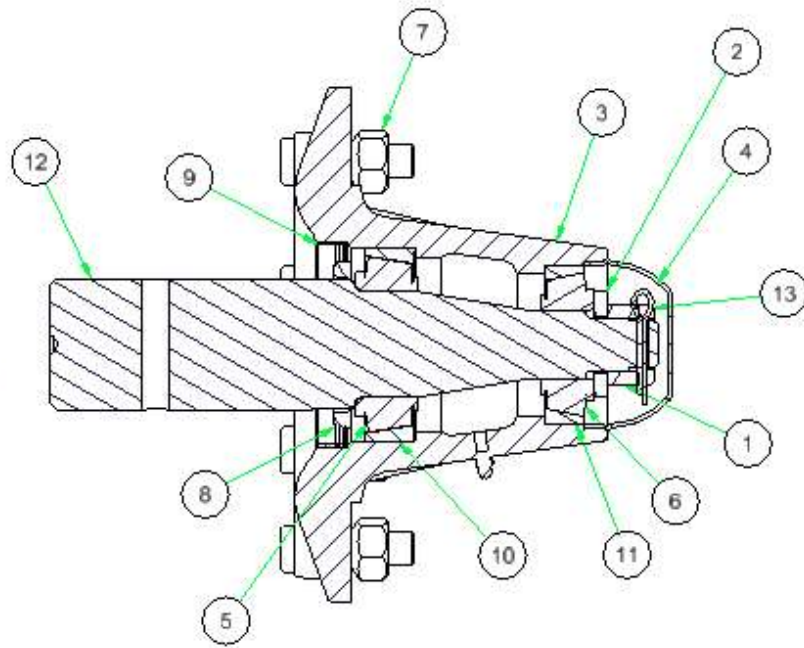

2/12/2021

8K1105.iam/HUB PARTS

SECTION 4 - PARTS

8K1100		
ITEM	PN	DESCRIPTION
1	8D5217	BEARING IN 517 OUT 614 & 618
2	8D5312	NUT 1"-14NF HEX SLOT GR2 PLN
3	8D5319	WASHER 1" AXLE
4	8D5332	RACE H517 & H614
5	8R6901	AXLE H614 STR 2"CR X 10"
6	8R6911	HUB H614 W/CUPS&ZRK 6 BLT GBGI
7	8R6913	HUB CAP H614 & H618
8	8R6914	BOLT WHEEL 9/16"-18 UNF- 1.25"
9	8R6917	BEARING INNER 614
10	8R6922	SEAL ASSY GBGI H614 HUB 00-
11	8R6925	RACE INNER H614
12	8X0415	COTTER PIN 3/16 X 1-1/2"

8K1105/8K1105S		
ITEM	PN	DESCRIPTION
1	8D5312	NUT 1"-14NF HEX SLOT GR2 PLN
2	8D5319	WASHER 1" AXLE
3	8K7111	812 HUB ASSEMBLY
4	8K7113	HUB CAP HD812
5	8K7117	BEARING INNER HD812
6	8K7118	BEARING OUTER HD812
7	8K7123	NUT WHEEL BOLT 5/8-18UNF 97-
8	8K7127	SEAL TRPL LIP EXTRNL HD812 06-
9	8K7128	SEAL SLEEVE HD812 06-
10	8K7130	RACE INNER FOR HD812
11	8K7132	RACE OUTER FOR HD812
12	8K7150	SPINDLE HD812 X 11.5" (2.5"DIA.)
	8K7150S	SPINDLE HD812 X 11.5 (2 DIA.)
13	8X0415	COTTER PIN 3/16 X 1-1/2"

SECTION 4 - PARTS

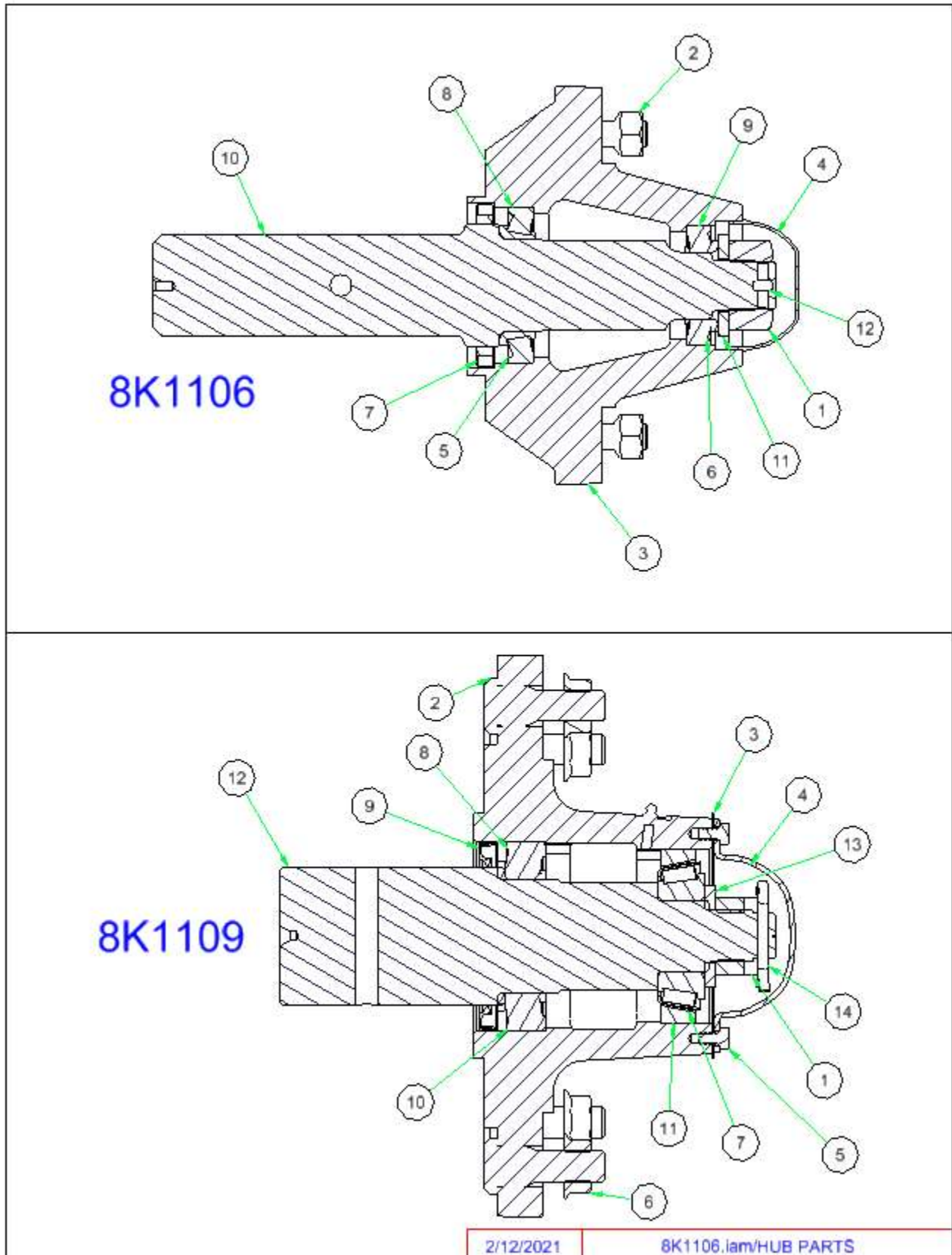

SECTION 4 - PARTS

8K1106		
ITEM	PN	DESCRIPTION
1	8D5314	NUT 1-1/4"-12 HEX SLOT GR2 PLN
2	8K7123	NUT WHEEL BOLT 5/8-18UNF 97-
3	8K7340	HUB HD817 W/CUPS&SRK 8BLT3LIP
4	8K7341	HUB CAP HD817
5	8K7342	BEARING INNER HD817
6	8K7343	BEARING OUTER HD817
7	8K7344	SEAL 3"ID HD817 SE42
8	8K7346	RACE INNER HD817
9	8K7347	RACE GBGI & OTR 817
10	8K7349	AXLE HD817X 15.25" (2.5"DIA.RCVR)
11	8X0328	WASHER 1.312"IDX2.5 OD-1/4" BL
12	8X0414	COTTER PIN 1/4 X 2" YZ

8K1109		
ITEM	PN	DESCRIPTION
1	8D5314	NUT 1-1/4"-12 HEX SLOT GR2 PLN
2	8K7211	HUB H1010 W/CUPS&ZRK 10BLT 12K
3	8K7212	GASKET HUB CAP H1010
4	8K7213	HUB CAP H1010
5	8K7214	BOLT HUB CAP H1010
6	8K7216	NUT 3/4"-16UNF FLANGE
7	8K7218	BEARING INNER 15K H1010
8	8K7219	BEARING INNER 15K H1010
9	8K7220	SEAL 3" ID 12K H1010
10	8K7231	RACE INNER 15K H1010
11	8K7232	RACE OUTER 12K&15K H1010
12	8K7251	3.375' SPINDLE FOR 15K HUB
13	8X0328	WASHER 1.312"IDX2.5 OD-1/4" BL
14	8X0414	COTTER PIN 1/4 X 2" YZ

JIC FITTINGS MUST BE TIGHTENED ONE FLAT PAST WRENCH RESISTENCE.
ORB FITTINGS MUST BE TIGHTENED TO SPECIFIED TORQUE QUALIFICATIONS.

SAVED OR PRINTED COPIES ARE UNCONTROLLED

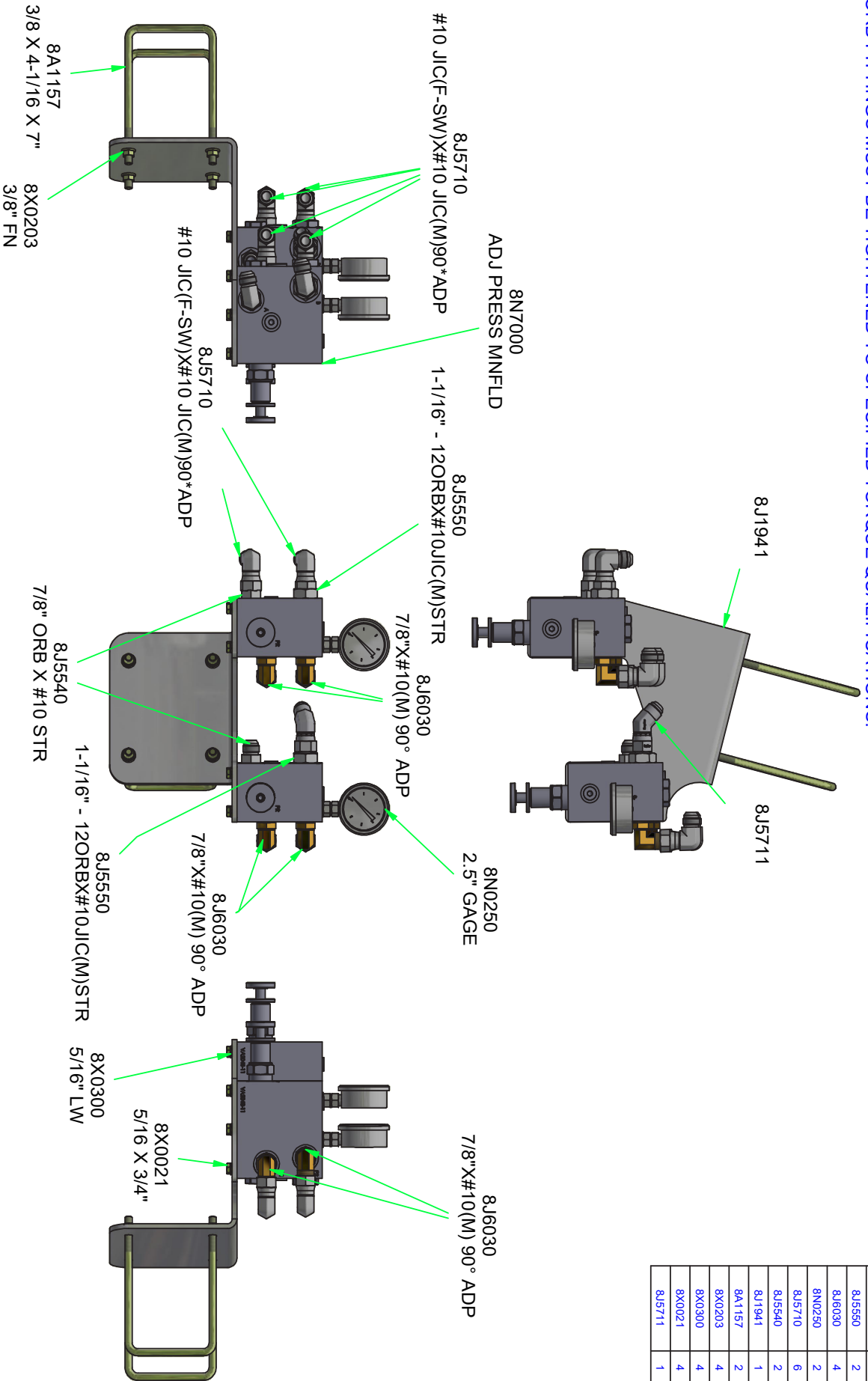

PN	QTY
8N7000	2
8J5550	2
8J6030	4
8N0250	2
8J5710	6
8J5540	2
8J1941	1
8A1157	2
8X0203	4
8X0300	4
8X0021	4
8J5711	1

REV	ECN	DESIGNER	CHECKED BY	CHECKED DATE	DESIGNER	ENGINEER	DRAWING DATE	MASS	SHEET SIZE	SHEET	PART NUMBER	DESCRIPTION
A		CCV			CCV	CCV	3/29/2024	30.452 lbmass	A	1 OF 1	30' HYD.	

ALL DIMENSIONS IN INCHES UNLESS OTHERWISE NOTED

SUMMERS®

TOLERANCE (IN INCHES) UNLESS OTHERWISE NOTED

FRACTIONAL ±1/32" X ±.000" ANGLES ±1° XXX ±.005"

THE INFORMATION CONTAINED IN THIS DRAWING IS THE SOLE PROPERTY OF SUMMERS MFG. CO. ANY REPRODUCTION IN PART OR WHOLE WITHOUT THE WRITTEN PERMISSION OF SUMMERS MFG. CO. IS PROHIBITED.

40' - 50' HITCH HYDRAULIC CIRCUIT

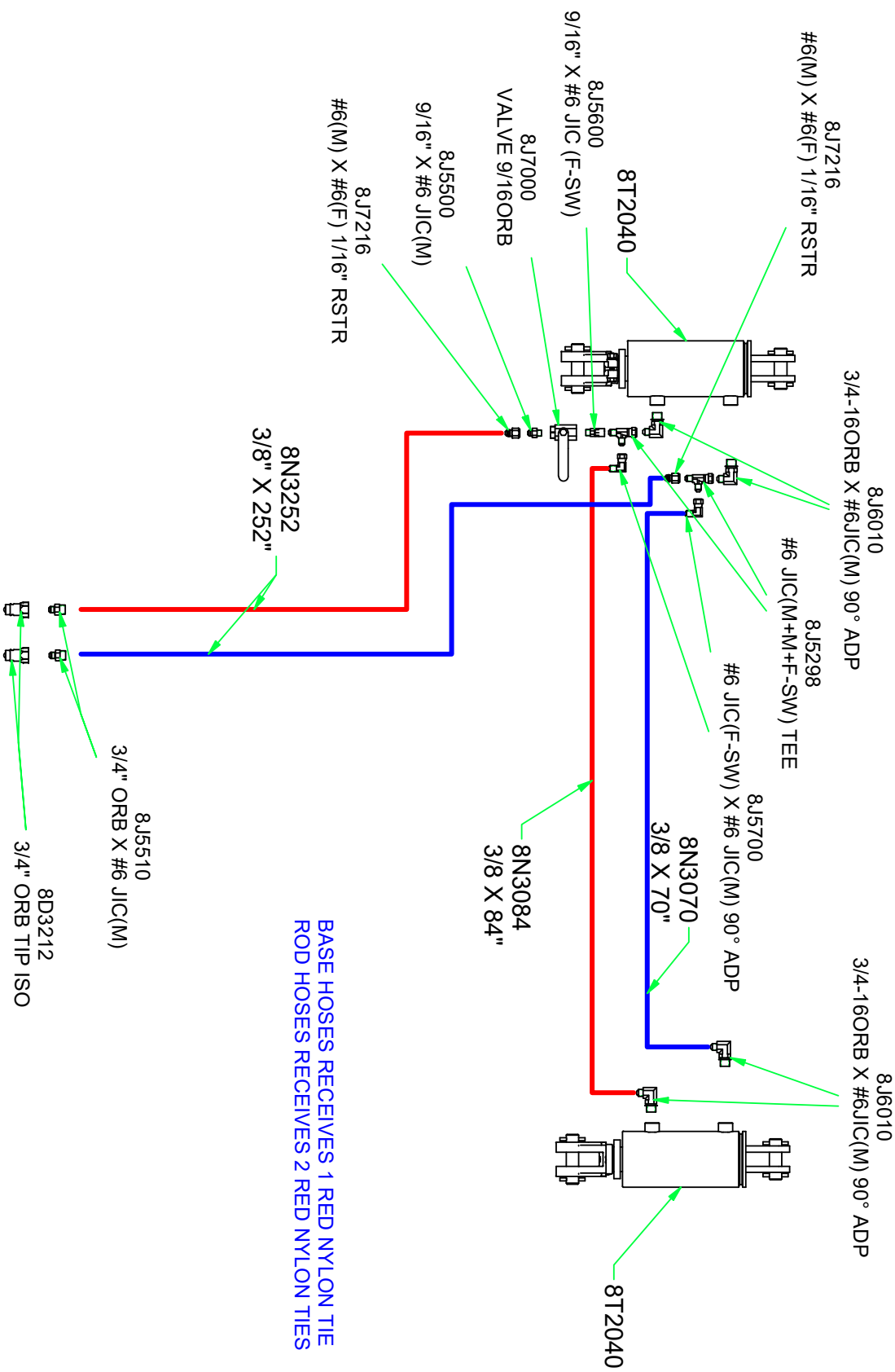

BASE HOSES RECEIVES 1 RED NYLON TIE
 ROD HOSES RECEIVES 2 RED NYLON TIES

30' HITCH HYDRAULIC CIRCUIT

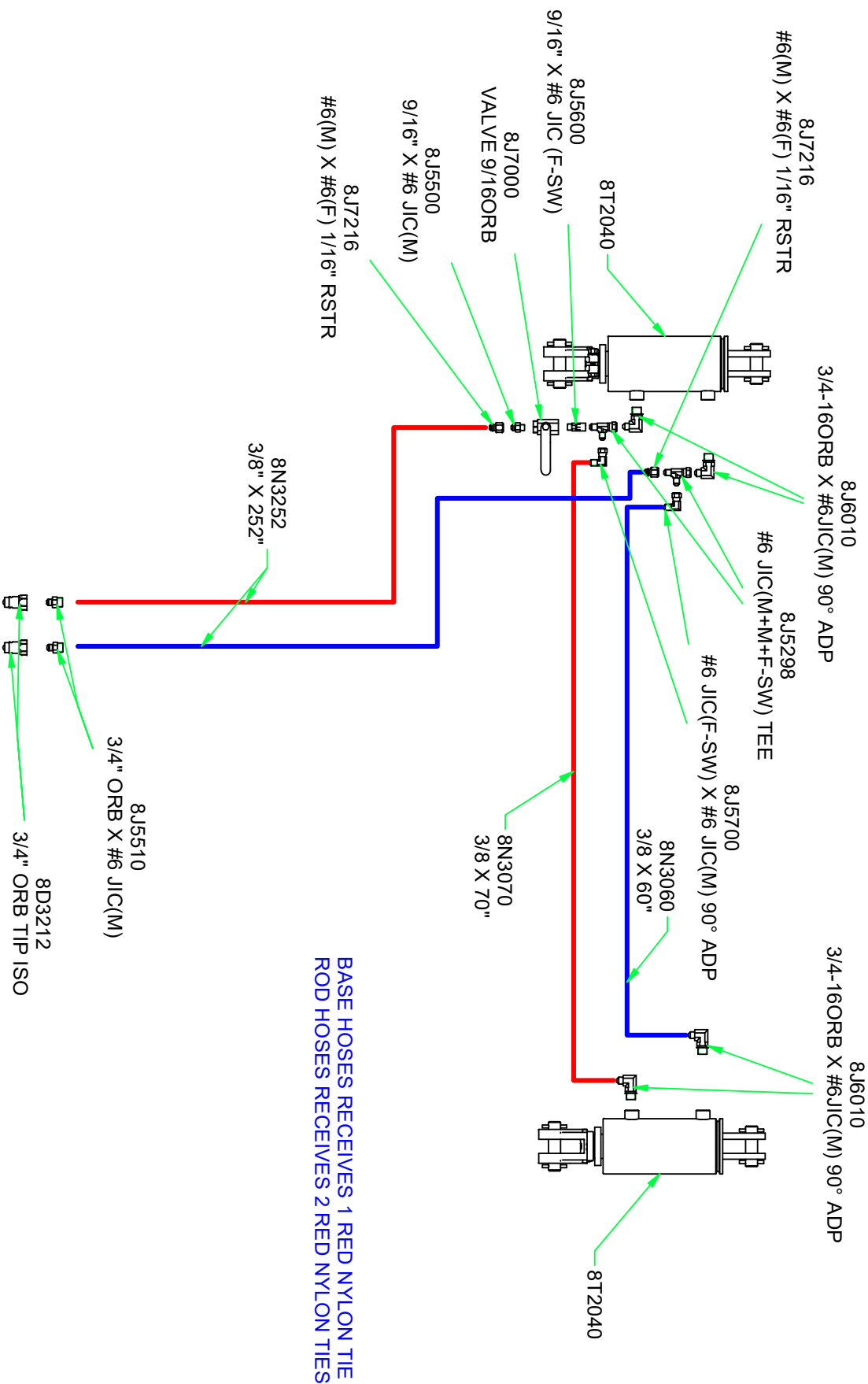

BASE HOSES RECEIVES 1 RED NYLON TIE
 ROD HOSES RECEIVES 2 RED NYLON TIES

30' WING FOLD/DOWN PRESSURE HYDRAULIC CIRCUIT

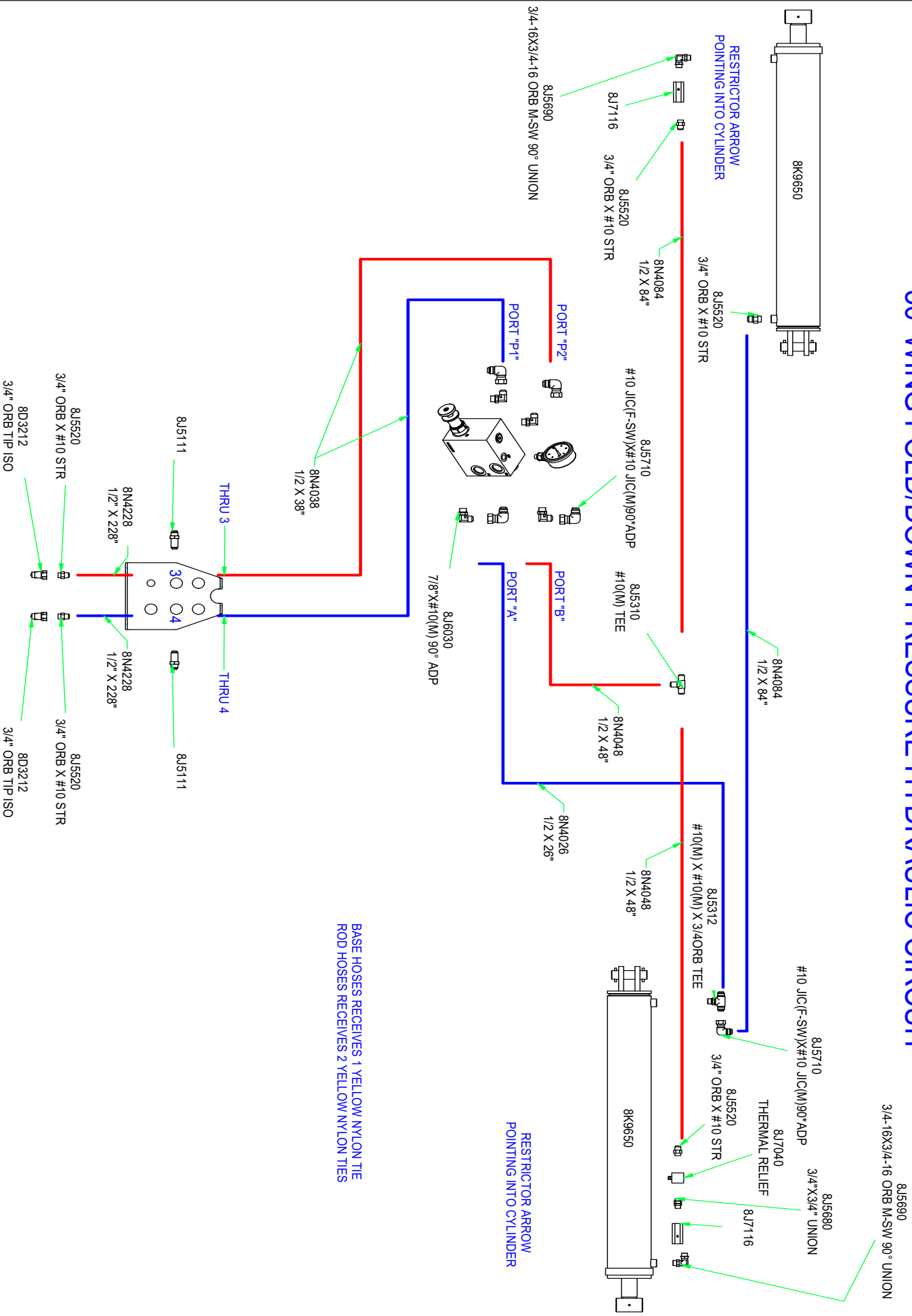

SECTION 4 - PARTS

40' BASKET DOWN PRESSURE HYDRAULIC CIRCUIT

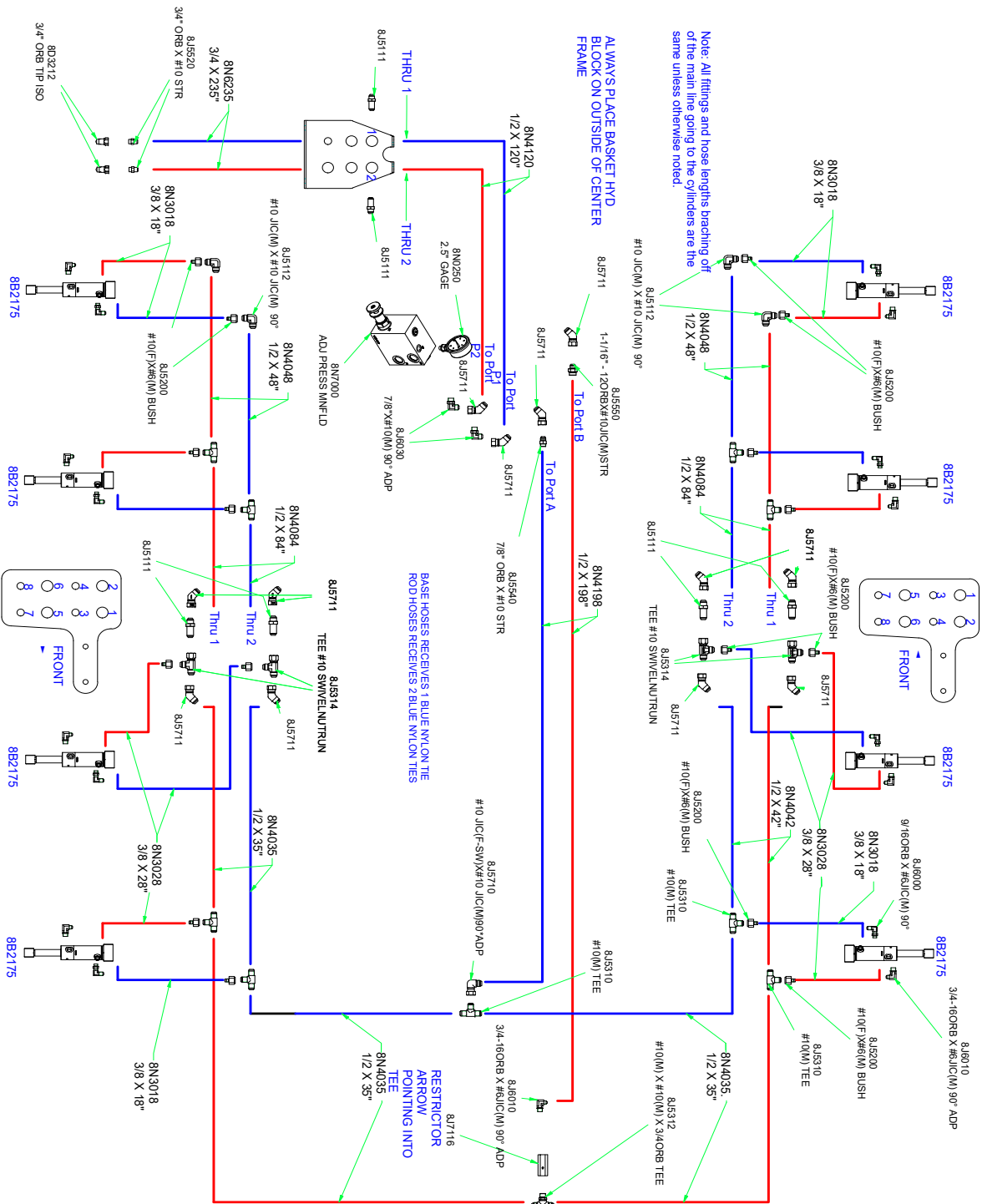

SECTION 4 - PARTS

50' BASKET DOWN PRESSURE HYDRAULIC CIRCUIT

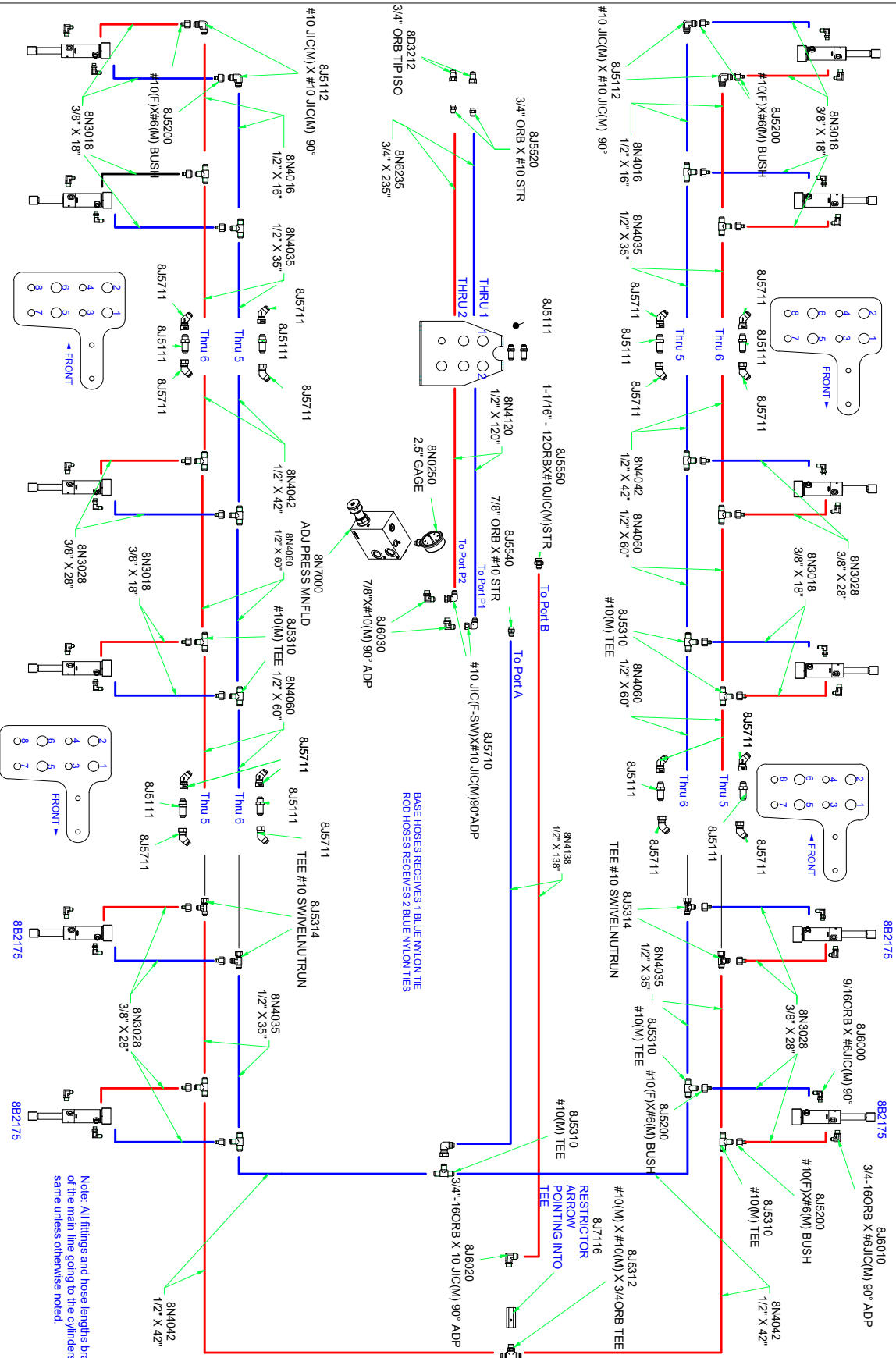

Note: All fittings and hose lengths branching off of the main line going to the cylinders are the same unless otherwise noted.

SECTION 4 - PARTS

8B2540	LIFTARM OSC AXL-RNGD
8A1155	U-BOLT 3/8 X 6-1/16 X 5" SQ
8A1157	U-BOLT 3/8 X 4-1/16 X 7" SQ
8A1954	TUBING GAGE LINE 1/4"OD PER FT
8A4048	NYLON TIE .18 X 11"
8A4050	NYLON TIE .30 X 8-7/8"
8A4052	NYLON TIE .30 X 15.25"
8A4054	NYLON TIE .30 X 24" BLK
8B1215	WING LOCK TAB VRT 15-
8B1217	WING LOCK TAB SPCR 15-
8B1270B	OSC AXLE SPNDLE HLDR 2.5" 18-
8B2025	PIN 1-1/2" X 5.375" YZ
8B2536	SPACER .76"ID X 4"
8B2560	TRANSREST MNT PLATE
8C1755	U-BOLT 3/4 X 6-1/16 X 6" SQ
8CC0800	DEPTH INDICATOR CYL CLAMP11-
8CC0810	DEPTH INDICATOR POINTER 12-
8CC0815	DEPTH INDICATOR POINTRCLAMP
8D0760	HITCH ARTIC. BALL CAT 4
8D0790	HITCH SHIM PTD
8D2470	SAFETY CHAIN 30400# 7/16" X 5'
8D3212	MALE TIP 3/4"-16 ORB ISO
8D8523	JACK 8000# DROPLEG 5/8X4.25PIN
8D9108	ROLL PIN 1/4 X 2" ZINC
8D9110	HAIRPIN CLIP LARGE (1"CYL PIN)
8D9516	HYD CYL 5 X 16" 3000PSI
8G2284	NYLON TIE .187 X 7-1/2" YELLOW
8G2285	NYLON TIE .187 X 7-1/2" GREEN
8G2286	NYLON TIE .187 X 7-1/2" BLUE
8J0190	SCRAPER FLAT SUPRCOULTR 00-
8J0192	SCRAPER CASTSPOOL SUPRCLTR11-
8J0910	STL 1-1/8 X 10"C-C LNK BLK 09-
8J0920	LINK PT 1 TO 2 (1 STFNR) 09-
8J1195	WEIGHT HTCH SCS OUTER
8J1197	WEIGHT HTCH SCS INNER
8J1200P	HITCH 40'-50' SCS-PNTD
8J1202P	FRAME WING 30' SCS-L-PTD
8J1205P	FRAME WING 30' SCS-R-PTD
8J1208P	FRAME CENTER 30' SCS-PTD
8J1210P	FRAME CENTER 3 SEC SCS-PTD

8J1212P	FRAME CENTER 5 SEC SCS-PTD
8J1215P	FRAME WING 40' SCS-L-PTD
8J1217P	FRAME WING 40' SCS-R-PTD
8J1220P	FRAME WING PT1 50' SCS-L-PTD
8J1222P	FRAME WING PT1 50' SCS-R-PTD
8J1225P	FRAME WING PT2 50' SCS-PTD
8J1230	TRUSS CENTER FRNT 3 SEC SCS
8J1232	TRUSS WING FRNT 3 SEC SCS
8J1234	TRUSS 3SEC WING CYL ATTCH SCS
8J1236	TRUSS CENTER SCS
8J1237	TRUSS CENTER 30' SCS
8J1238	TRUSS WING 5 SEC SCS
8J1239	TRUSS CYL ATTCH 30' SCS
8J1240	WING REST TUBE SCS
8J1241	WING REST TUBE 30' SCS
8J1242	TRANSREST BRACE SCS
8J1243	TRANSREST MNT PLATE 30' SCS
8J1244	WING REST PT2 SCS
8J1246	WINGFOLD CYL ATTACH SCS
8J1248	JACK SPOOL MNT-REAR
8J1250	A-FRAME SCS
8J1260	LIFTARM RIGID SCS
8J1268	SPACER 1"ID X 1"W
8J1270L	CYL ATTCH VF285 OSC-L
8J1270R	CYL ATTCH VF285 OSC-R
8J1272L	CYL ATTCH VF385 OSC-L
8J1272R	CYL ATTCH VF385 OSC-R
8J1274L	CYL ATTCH VF285 RIGID-L
8J1274R	CYL ATTCH VF285 RIGID-R
8J1276	WINGFOLD CYL ATTACH 30' SCS
8J1277	WINGFOLD CYL ATTACH 30' SCS
8J1290B	C-SHANK MNT-PIVOT
8J1295	C-SHANK MNT-1-5 DEGREE
8J1930	GAUGE 4" STROKE
8J1932	BACKER 4" STROKE GAGE
8J1940	VALVE MNT - SCS
8J3256	SCRAPER MNT TUBE-56"SCLTR00-
8J3260SF	GANG 6BLADE SAMCLTR-FRONT
8J3260SR	GANG 6BLADE SAMCLTR-REAR
8J3276	SCRAPER MNT TUBE-76"SCLTR00-

SECTION 4 - PARTS

8J3280SF	GANG 8BLADE SAMCLTR-FRONT
8J3280SR	GANG 8BLADE SAMCLTR-REAR
8J4167	OSC AXLE SPNDL HLDR 3.375" 15-
8J4168B	OSC AXLE SPNDLE HLDR MNT 18-
8J5101	#6 JIC(M) X #6 JIC(M) BLKHD
8J5110	#10 JIC(M) X #10 JIC(M) UNION
8J5111	#10 JIC(M) X #10 JIC(M) BLKHD
8J5200	#10 JIC(F) X #6 JIC(M)HEX BUSH
8J5298	TEE #6 SWIVELNUTRUN(M+M+F-SW)
8J5300	TEE #6 JIC (MALE) 3X
8J5310	TEE #10 JIC (MALE) 3X
8J5312	TEE #10JIC(M2X)X3/4-16ORBBRNCH
8J5355	CROSS #10 JIC(M4X)
8J5500	9/16"-18 ORB X #6 JIC(M) STR
8J5510	3/4"-16 ORB X #6 JIC(M) STR
8J5520	3/4"-16 ORB X #10 JIC(M) STR
8J5540	7/8"-14 ORB X #10 JIC(M) STR
8J5550	1-1/16" - 12ORB X #10JIC(M)STR
8J5600	9/16"-18 ORB X #6 JIC(F-SW)STR
8J5680	3/4"-16 ORB X 3/4"-16ORB UNION
8J5690	3/4-16X3/4-16 ORB M-SW90*UNION
8J5700	#6 JIC(F-SW) X #6 JIC(M)90*ADP
8J5710	#10 JIC(F-SW)X#10 JIC(M)90*ADP
8J6010	3/4"-16 ORB X #6 JIC(M)90*ADP
8J6020	3/4"-16 ORB X #10 JIC(M)90*ADP
8J6030	7/8"-14 ORB X #10 JIC(M)90*ADP
8J7000	BALL VALVE HYD 9/16"-18ORB(2X)
8J7040	THERMAL RELIEF MANIFLD 4000PSI
8J7116	3/4"-16 ORB(2X)1WAY 1/16"RESTR
8J7216	#6JIC(M)X6JIC(F)1/16"RSTR BLKZ
8J8650	BOX 50' SAMURAI CLTR
8K1105	HUB&AXLE ASSY HD812(2.5"RCVR)
8K1106	HUB&AXLE ASSY HD817(2.5"RCVR)
8K1109	HUB&AXLE W/1010 15K 3.38"03-
8K1540	TUBE 2-1/4X1.27ID- 1/2" DSK84-
8K1610	PIN 3/4 X 7.25" TRNSPRTLCK 84-
8K3002	WRENCH GANG 3-1/8" HEX BLCK00-
8K5505	U-BOLT 3/4 X 2-1/8 X 4-1/4" SQ
8K5515	U-BOLT 3/4 X 4-1/16 X 6" SQ
8K5520	U-BOLT 3/4 X 6-1/8 X 7-1/2" SQ

8K7410	285/70R 19.5 ON 19.5X8.25X8WHL
8K7540	VF385/65R22.5-22.5X11.75X10WHL
8K8005	TUBE LGHT BRKT SHRT 1.5SQ PNTD
8K8010	TUBE LGHT BRCKT 1.5SQ PNTD 00-
8K8020	STL 12GA MNTNG BRCKT LIGHT 00-
8K8030A	MODULE AG ENHNCDW/BRAKE6PIN08-
8K8071	MAIN HRNSS 7PN 26' W/BRAKE 09-
8K8076	EXT HARNESS 12' DEUTSCH 16-
8K8090B	LIGHT LED AMBER 2WR DTSCH 12-
8K8095B	LIGHT LED RED 3WIRE DTSCH 12-
8K8104	EXT HARNESS 13'2WIRE DTSCH 07-
8K8440C	HYD CYL 4 X 8" RPHS 2"ROD
8K8445C	HYD CYL 4.5 X 8" RPHS 2"ROD
8K8452C	HYD CYL 5 X 8" RPHS 2.12"RD
8K8455	HYD CYL 5.5 X 8" RPHS 2.25RD
8K8460	HYD CYL 6 X 8" RPHS 2.38RD
8K9164	STROKE CNTRL 1/2" 2.3"ROD 11-
8K9166	STROKE CNTRL 3/4" 2.3"ROD 11-
8K9168	STROKE CNTRL 1" 2.3" ROD 11-
8K9170	STROKE CNTRL 1-1/4" 2.3RD 11-
8K9200	TRNS LCK FRMD 7.5"(2-3/8RD)10-
8K9650	HYD CYL 5 X 36" W/3" STOP TUBE
8L0036	DOUBLE PILOT OPERATED CHECK
8L0258	U-BOLT 5/16 X 1-1/2 X 2-1/2"SQ
8L4702A	CENTER HOSE PROTECTR BRKT05-
8N0200	BULKHEAD PLATE - HITCH
8N0202	BULKHEAD PLATE - A-FRAME
8N0250	HYD PRESSURE GAGE 2.5"
8N0525	HOSE WRAP 2.5" X 25' BLK
8N0700	HYD HOSE ARM
8N0704	HYD HOSE TIP HOLDER-4 PAIR
8N0705	MANUAL HOLDER MNT
8N3028	3/8X 28"HYD HOSE #6FJX3000PSI
8N3048	3/8X 48"HYD HOSE #6FJX3000PSI
8N3070	3/8X 70"HYD HOSE #6FJX3000PSI
8N3084	3/8X 84"HYD HOSE #6FJX3000PSI
8N3106	3/8X 106"HYD HOSE #6FJX3000PSI
8N3108	3/8X 108"HYD HOSE #6FJX3000PSI
8N3116	3/8X 116" HYD HOSE#6FJX3000PSI
8N3150	3/8X 150"HYD HOSE #6FJX3000PSI

SECTION 4 - PARTS

8N3180	3/8X 180"HYD HOSE #6FJX3000PSI
8N3228	3/8X 228"HYD HOSE #6FJX3000PSI
8N3252	3/8X 252"HYD HOSE #6FJX3000PSI
8N3288	3/8X 288"HYD HOSE #6FJX3000PSI
8N4026	1/2X 26"HYD HOSE#10FJX3000PSI
8N4038	1/2X 38" HYD HOSE#10FJX3000PSI
8N4048	1/2X 48"HYD HOSE#10FJX3000PSI
8N4060	1/2X 60"HYD HOSE#10FJX3000PSI
8N4074	1/2X 74"HYD HOSE#10FJX3000PSI
8N4084	1/2X 84"HYD HOSE#10FJX3000PSI
8N4085	1/2X 85" HYD HOSE#10FJX3000PSI
8N4138	1/2X 138"HYD HOSE#10FJX3000PSI
8N4160	1/2X 160"HYD HOSE#10FJX3000PSI
8N4180	1/2X 180"HYD HOSE#10FJX3000PSI
8N4228	1/2X 228"HYD HOSE#10FJX3000PSI
8N6235	3/4X 235"HYD HOSE#10FJX3000PSI
8N7000	ADJ DOWN PRESSURE MANIFLD 12-
8P3900	PIN 2 X 11-1/8" HARDENED
8P3910	PIN 2 X 13-1/2" HARDENED
8R6814	SPLITSTEELBUSH 1.5X1.25"ID-.75"
8R6815	SPLITSTEELBUSH 1.5X1.25"ID-1"
8S1120	SIGN SLOW MOVING VEHICLE(SMV)
8S1124	MOUNTING SOCKET SMV SIGN
8S1126	MNT SPADE W/HRDWR SMV SIGN
8S2990	HYD HOSE CLAMP-LARGE-NYLON
8S3095	CAPLUG FITS ISO HYD COUPLR 08-
8T2040	HYD CYL 4 X 4" 3500PSI 09-
8T2514	SPACER WNGFLT2.25ODX9/16" 99-
8T3300	BOLT PIVOT CHSLTRP&WNGFLT YZ
8T3608	PIN 1-1/2 X 7-1/16"HRDND&CHROM
8T3640	PIN 1-1/2 X 19" HARDEND 98-
8T8100	VALVE SEQUENCE WING FOLD 99-
8X0001	BOLT 3/8-16NC X 3/4" GR5 YZ
8X0015	BOLT 3/8-16NC X 3-3/4" GR5 YZ
8X0021	BOLT 5/16-18NC X 3/4" GR5 YZ
8X0021B	BOLT 5/16-18NC X 1-1/4"GR5 YZ
8X0044	BOLT 7/16-14NC X 3-1/2"GR5 YZ
8X0074	BOLT 1/2-13NC X 4-1/2" GR5 YZ
8X0075	BOLT 1/2-13NC X 6" GR5 YZ
8X0077	BOLT 1/2-13NC X 7-1/2" GR5 YZ

8X0095	BOLT 5/8-11NC X 5" GR5 YZ
8X0110	BOLT 3/4-10NC X 1-1/4" GR5 YZ
8X0114	BOLT 3/4-10NC X 3" GR5 YZ
8X0115	BOLT 3/4-10NC X 3-1/2" GR5 YZ
8X0119	BOLT 3/4-10NC X 7-1/2" GR5 YZ
8X0120	BOLT 3/4-10NC X 9" GR5 YZ
8X0121	BOLT 3/4-10NC X 6-1/2" GR5 YZ
8X0121A	BOLT 3/4-10NCX6-1/2" -1.38"THD
8X0129	BOLT 3/4-10NC X 11" GR5 YZ
8X0130	BOLT 7/8-9NC X 2" GR5 YZ
8X0133	BOLT 7/8-9NC X 3" GR5 YZ
8X0140	BOLT 1-8NCX7" W/1.5"THDGR5 YZ
8X0146	BOLT 1-8NC X 8-1/2" GR5 YZ
8X0151	BOLT 1-1/4"-7NC X 7.5" GR8 YZ
8X0152	BOLT 1-1/4-7NC X 3.75 FULLTHD
8X0170	SCREW 8 X .75" FLANGE HD
8X0202	NUT 3/8"-16NC NY-LOCK GR2 YZ
8X0203	NUT 3/8"-16NC SERFLANG GR2 YZ
8X0208	NUT 8-32 HEX YZ SER FLNG
8X0211	NUT 5/16"-18NC SERFLANG GR2 YZ
8X0234	NUT 7/16"-14NC NY-LOCK GR2 YZ
8X0242	NUT 1/2"-13NC NY-LOCK GR2 YZ
8X0246	NUT 1/2"-13NC SERFLANG GR2 YZ
8X0253	NUT 5/8"-11NC NY-LOCK GR2 YZ
8X0260	NUT 3/4"-10NC HEX GR2 YZ
8X0265	NUT 3/4"-10NC CNTRLOCK GR2 YZ
8X0266	NUT 3/4"-10NC SERFLANG GR2 YZ
8X0270	NUT 7/8"-9NC CNTRLOCK GR2 YZ
8X0281	NUT 1"-8NC NY-LOCK GR2 YZ
8X0282	NUT 1"-14TPI TOPLOCK GR B Z
8X0283	NUT 1-1/4"-7NC JAM GR2 YZ
8X0288	NUT 1-1/4"-7NC NY-LOCK GR8 YZ
8X0300	LOCKWASHER 5/16" YLW ZNC
8X0304	LOCKWASHER 5/8" YLW ZNC
8X0306	LOCKWASHER 3/4" YLW ZNC
8X0316	WASHER 1" SAE FLAT YZ
8X0317	WASHER 3/4" SAE FLAT YZ
8X0318	WASHER 3/4"(13/16"ID)FLAT YZ
8X0323	WASHER 5/8" SAE FLAT YZ
8X0329	WASHER 5/16"(3/8" ID)FLAT YZ

SECTION 4 - PARTS

8X0354	WASHER 1-1/2"IDX2.25"X14GA YZ
8X0402	HAIRPIN CLIP 1/8 X 2-9/16"
8X0440	CLEVIS PIN 5/8 X 3-7/8" YZ
8X0523	ROLL PIN 5/16 X 2-1/2" PLN
8X0558	RIVET 3/16 SML FLNG .375
8X0803	STL .25 MODULE BRACKET 16-
8X1110	CRG 3/8-16NC X 1" GR2 ZN
8X1115	CRG 3/8-16NC X 1-1/2" GR2 ZN
8X3110	SLEEVEBRNG 1.125X1" ID- 1"
8X3130	SLEEVEBRNG 1.656X1.5" ID- 1.5"
8X3140	SLEEVEBRNG 2.188X2" ID- 2"
8Z0052	DECAL PATENT PROTECT 1.5X3.5"
8Z0075	DECAL TRNSPRT LCK WARNING TILL
8Z0087	DECAL"WARNING"PINCH POINT03-
8Z0099	DECAL"WARNING" DISCONNECT IMP
8Z0100	DECAL MADE IN USA
8Z0102	DECAL"IMPORTANT" REAR JACK(S)
8Z0202	DECAL 3.5" SUMMERS 14-
8Z0204	DECAL 5.5" SUMMERS 14-
8Z0276	DECAL GENERAL CAUTION 91-
8Z0340	DECAL REPHASING CYLINDERS
8Z0342	DECAL INSTALL CYLINDER LOCKS
8Z0344	DECAL WING DANGER
8Z0346	DECAL ELECTROCUTION-TILLAGE
8Z0502	DECAL WING PRESSURE
8Z0503	DECAL BSKT PRESSURE
8Z0800	REFLECTOR AMBER ADHSVBCK98-
8Z0805	REFLCTR REDORANGE ADHSVBK99-
8Z0810	REFLECTOR RED ADHSV-BACK 98-
8Z1010	MANUAL HOLDER TUBE 18-
8Z2534	DECAL LIFT-HTCH-WNG-BSKT
8Z2560	DECAL 4.5 X 42.2" SC SAMURAI

History of Summers Manufacturing Co., Inc.

1965 – Summers Manufacturing is founded by Harley Summers, who purchases patent rights for Goebel truck and pickup hoists from the Goebel Brothers of Lehr, ND. These hoists, produced in Harley Summers' blacksmith shop the first year, were distributed nationwide by a Cincinnati, Ohio, dealer. With increasing sales, the company soon outgrows the small shop. Summers wins the Herman harrow contract, beginning the company's Herman culti-harrow line. Summers builds a 7,200 square-foot factory in Maddock to meet the demand for truck and pickup hoists, as well as Herman harrows.

1969 – Firm incorporates and becomes officially known as Summers Manufacturing Company, Inc.

1970 – Summers purchases rights to manufacture/market the Herman Harrow.

1973 – Company builds new 20,000 square-foot plant and offices in Maddock, adding a 20,000 square-foot assembly plant in the fall of 1975 (completed in January 1976), bringing total square footage of Maddock factories to 47,000.

1977 – Summers introduces the Agri-sprayer, used in conjunction with the Herman culti-harrow to incorporate herbicides and liquid fertilizer.

1980 – Company purchases manufacturing and distributing rights to Crown rockpickers from Crown Manufacturers of Regina, Saskatchewan. This forces another expansion project – a 26,000 square foot factory on a 24 acre site in Devils Lake, ND Industrial Park.

1981 – Company establishes a branch facility in Regina, Saskatchewan.

1982 – Devils Lake plant begins operations in January, manufacturing supersprayers and rockpickers. The Maddock factory begins producing the Superweeder, a combination cultivator and harrow.

1983 – Summers buys manufacturing and distributing rights to the Fargo Field Sprayer line from Mid America Steel (formerly Fargo Foundry), Fargo. This field sprayer line is manufactured at the Devils Lake plant. Harley Summers is selected North Dakota's small-businessman of the year by the Small Business Administration.

1984 – Herman Diamond Disk, a disk harrow made in a diamond shape to reduce blade breakage from rocks, comes off the assembly line.

1985 – Summers signs a contract with Melroe Company of Bismarck to obtain exclusive manufacturing rights to the Melroe harrow line.

1989 – Summers purchases TorMaster Company of Hordean, Manitoba, giving the company a line of rolling packer equipment, comprised of harrow packers and hydraulic fold coil packers.

1992 – A new engineering office/parts department is added to the Devils Lake factory.

1993 – Company adds two new products: a pickup-mounted sprayer with booms of 80 and 90 feet, and the Summers Superharrow, an extra-heavyduty residue-management tool designed for the minimum and no-till farmer.

1994 – a 50 by 125 foot addition to the Maddock factory is completed. Construction begins on a 24,576 square-foot addition to the Devils Lake factory, which enables the company to increase production of truck-mounted and pull-type supersprayers and rockpickers.

1996 – 1500 square foot office area added to the Maddock plant. Company introduces Chisel Plow with floating hitch and 700# trip assembly.

1997 – 16,800 square foot warehouse in Maddock purchased from local business.

1999 - Company introduces the Ultimate suspended boom trailer sprayer with hydraulic folding booms. Additional sizes added to the Chisel Plow line, now ranging from 28' to 54'.

2000 - Company introduces the Supercoultter, the innovative solution for excessive field residue management on no-till, minimum-till, and conventional-till farming operations.

2001 - Cold storage building completed at Devils Lake. Company extends boom lengths up to 110 feet on the Ultimate Supersprayer.

2002 - Company adds a warehouse and service man in Aberdeen, SD.

2003 - Company introduces the Ultimate NT Supersprayer featuring a bolt on axle for easier adjustment, and a new family of tanks that feature a drainable sump and a common width dimension.

2004 - A 124 ft. x 310 ft. addition is added onto the current Devils Lake plant.

2005 - The Summers Superroller is added to the "Field Tested Tough" product line. Additional sizes of 56', 58' and 60' are added to the Superchisel line. Ultimate-Ultra NT Supersprayer introduced featuring 120' & 133' booms.

2006 - The Summers Coulter-Chisel, Rolling Choppers and 30' Superroller were included in product line.

2007 - 62' & 84' 5 Section Landrollers and a 20' Coulter-Chisel were introduced.

2008 - Disk-Chisels, ranging from 16' to 40' widths, are added to product line.

2009 – M105 and M108 Mounted Harrows added to selection of Mounted Attachments. SuperHarrow 2650, 50' SuperCoulter, Hydraulic Fold Rolling Chopper and 36" diameter Landrollers introduced.

2010 – Rolling Basket and 47' Diamond Disk added to product line. A 124 ft. x 310 ft. addition to Devils Lake factory built for a state of the art paint system.

2011 – Additional Supercoultter sizes were added along with larger tires for tillage implements. Ultimate and Ultra Supersprayers received an additional tank size of 1650 gallons. Front Caster Wheel option was made available for chisel implements.

2012 – 41', 46' & 53' Trail Type Landroller added to product line. Additional Superchisel sizes of 16' & 20' were added.

2013 – DT9530 added to product line. Internal Scraper in Rolling Baskets introduced. Finishing Coulter Gang becomes standard on the Diamond Disk and 2510 DT. Corporate offices opened at Devils Lake plant. New building and location for the Aberdeen warehouse.

2014 – Introduced the VRT2530 (Variable Rate Tillage).

2015 – Introduced the VT Flex Applicator and Spray Fill Xpress.

2016 – Introduced the 3RT line of 3 point track fillers.

2018 – Introduced the VRT Renegade with IControl™.

2020 – Introduced the SuperCoulter Samurai™

Summers distributes on a wholesale level to dealers and distributors throughout markets in North Dakota, South Dakota, Minnesota, Montana, Iowa, Washington, Idaho, Oregon, Utah, Colorado, Kansas, Nebraska, Oklahoma, Texas, Manitoba, Saskatchewan, Alberta, British Columbia, Kazakhstan, Russia and Australia, making it an international company



SUMMERS[®]

... Field Tested TOUGH!



Tillage



Rock Picker



Land Rollers/Packers



Cultivators/Harrows



Mounted Attachments



Sprayers

